

Chamfering Drill

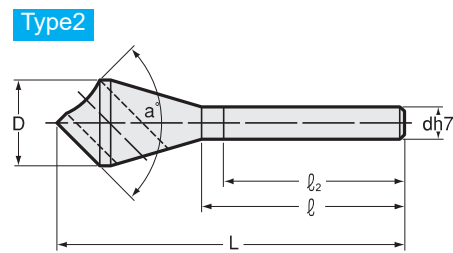
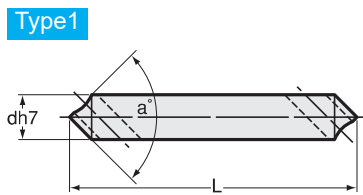

⚠ These products contain cobalt, which is a specified chemical substance classified as a Class 2 harmful substance.

① When using the chamfer for standard cutting:

Friction against the tool will not generate any dust or particles that are dangerous to machine operators. Therefore, measures to prevent health impairment are not necessary.

② When altering or regrinding the chamfer itself:

Cobalt dust will be generated, and measures to prevent health impairment are necessary. Please contact NT TOOL for details.

Application

For soft and ductile material. When machining hard and inductile material, please use "NEW CHAMFERING DRILL"

ST

Code	Model	Angle	Min pilot hole dia.	Max chamfering dia.	Type	d h7	D	ℓ	ℓ 2	L
0030 00004490	04 -ST4 -90°	90°	2	4	1	4	—	—	—	50
0030 00006690	06 -ST6 -90°	90°	3	6	1	6	—	—	—	50
0030 00008890	08 -ST8 -90°	90°	4	8	1	8	—	—	—	50
0030 00009690	09 -ST6 -90°	90°	4	9	2	6	10	42	38	55
0030 00014890	14 -ST8 -90°	90°	6	14	2	8	15	50	46	70
0030 00181090	18 -ST10 -90°	90°	8	18	2	10	20	70	66	100
0030 00231290	23 -ST12 -90°	90°	10	23	2	12	25	73	69	110
0030 00281290	28 -ST12 -90°	90°	12	28	2	12	30	70	66	120

Type1



Type2

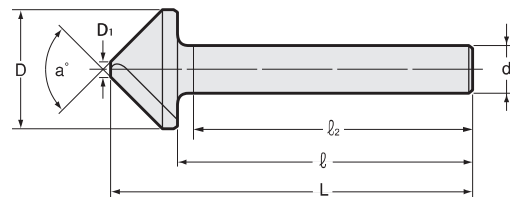

ST

Code	Model	Angle	Min pilot hole dia.	Max chamfering dia.	Type	d h7	D	D1	ℓ	ℓ 2	L
0010 00007890	07 -ST8 -90°	90°	1.5	7	1	8	—	—	—	—	55
0010 00015890	15 -ST8 -90°	90°	2	15	2	8	16	—	54	47	65
0010 00251090	25 -ST10 -90°	90°	6	25	2	10	26	3	65	58	80
0010 00351290	35 -ST12 -90°	90°	11	35	2	12	36	10	74	67	90
0010 00451290	45 -ST12 -90°	90°	16	45	2	12	46	15	76	68	95

Ordering Example

14 - ST 8 - 90°
 Max. chamfering dia. Shank size Angle
 Straight shank

Chamfering Series



Application	Chamfering drill	New chamfering drill	Chamfering holder
Deburring and chamfering for soft and ductile material.	○		○
Deburring, chamfering and countersinking for hard and in-ductile material		○	○
Chamfering and deburring with drilling machines.	○	○	○

Features	Chamfering drill	New chamfering drill	Chamfering holder
Various chamfering diameters with only one tool.	○	○	○
Smooth finish without chatter.	○	○	○
Easy positioning	○	○	○
Special gold coating			
Cobalt high speed steel used		○	
Indexable inserts reduces cutting tool costs. (No need for re-grinding.)			○
2 types (for hard and soft material) are available.			○