

NT-CT·A

Tite-Lock Milling Chuck

- Slim design milling chuck. Clicking sound tells completion of clamping.

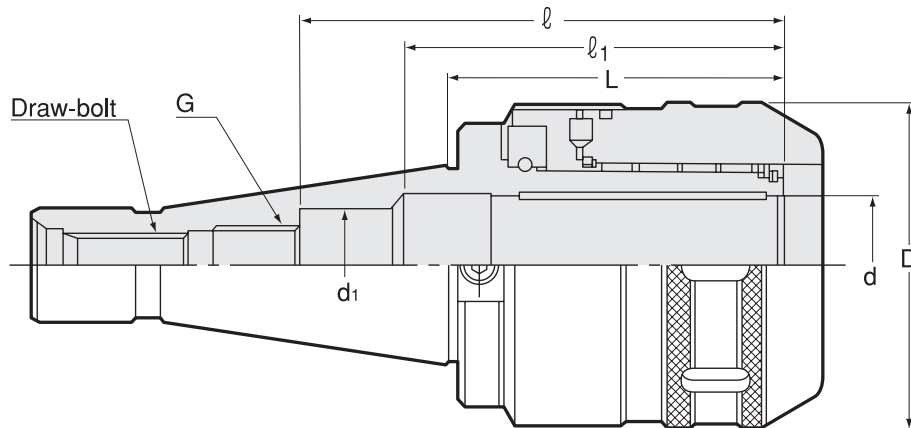

Caution

Please rotate the clamping ring counterclockwise more than 360 degrees after a cutting tool is removed.

Metric Sizes

Unit : Metric

| Code | Model | d | D | L | l | l1 | d1 | G P=1.0 | Draw-bolt | kg | Spanner |
|---------------|--------------------------------|----|----|----|-----|----|----|------------|-----------|-----|---------|
| 0710 01120070 | NT30 -CT20A -70 (W) | 20 | 52 | 70 | 80 | — | — | M12 | W1/2-12 | 1.0 | HS-2-20 |
| 0710 02120070 | -70 (U) | 20 | 52 | 70 | 80 | — | — | M12 | U1/2-13 | 1.0 | |
| 0710 01320070 | NT40 -CT20A -70 (U) | 20 | 52 | 70 | 80 | — | — | M12 | U5/8-11 | 1.4 | HS-2-20 |
| 0710 02320070 | -70 (M) | 20 | 52 | 70 | 80 | — | — | M12 | M16 P=2 | 1.4 | |
| 0710 01332075 | NT40 -CT32A -75 (U) * 1 | 32 | 73 | 75 | 108 | 76 | 26 | M18 | U5/8-11 | 2.0 | HS-3-32 |
| 0710 02332075 | -75 (M) * 1 | 32 | 73 | 75 | 108 | 76 | 26 | M18 | M16 P=2 | 2.0 | |
| 0710 01532085 | NT50 -CT32A -85 (U) | 32 | 73 | 85 | 120 | — | — | M18 | U1-8 | 4.0 | HS-3-32 |
| 0710 02532085 | -85 (M) | 32 | 73 | 85 | 120 | — | — | M18 | M24 P=3 | 4.0 | |
| 0710 01542085 | NT50 -CT42A -85 (U) | 42 | 88 | 85 | 120 | — | — | M18 | U1-8 | 4.4 | HS-4-42 |
| 0710 02542085 | -85 (M) | 42 | 88 | 85 | 120 | — | — | M18 | M24 P=3 | 4.4 | |

1. When ordering, indicate number of spanners required. "No charge" spanners are limited to number of milling chucks on order.
2. Tolerance of cutting tool shank must be h7.

Ordering Example

NT40 - CT 32 A - 75 (U)
 Shank size I.D. (d) Projection length (L) Draw-bolt length (L)

Spanner

P. 069



Accessories

Models with * 1 cannot be used with some accessories due to short l length.

| | Stopper Bolt  | Straight Collet  | | Morse Taper Adapter  | | Jacobs Adapter  | |
|-----|--|---|-------------|---|-------------|--|-------------|
| | BL (P.068) | MC (P.066) | MCA (P.067) | MA (P.068) | MAB (P.068) | JA (P.069) | JAB (P.069) |
| * 1 | Yes | Yes | Yes | No | Yes | No | Yes |

Min. chucking length

Without MC collet

| I.D. of Milling Chuck | Min. chucking length |
|-----------------------|----------------------|
| 20, 25 | 45 |
| 32, 42 | 60 |

With MC collet

| Collet I.D. | Min. chucking length |
|-------------|----------------------|
| 6, 8 | 30 |
| 10, 12 | 40 |
| 16, 20 | 45 |
| 25 | 55 |
| 32 | 60 |

Set of Milling Chuck (NT-CT·A)

| Code | Model | Milling chuck | Draw-bolt | Straight collet | Jacobs adapter |
|---------------|------------------------|-------------------|-----------|---|-------------------|
| 0710 05003020 | NT30 -CT20A (W) | NT30-CT20A-70 (W) | W1/2-12 | MC20-6, 8, 10, 12, 16 (1pc each) | JA20-JT6 (1pc) |
| 0710 06003020 | NT30 -CT20A (U) | NT30-CT20A-70 (U) | U1/2-13 | MC20-6, 8, 10, 12, 16 (1pc each) | JA20-JT6 (1pc) |
| 0710 05004020 | NT40 -CT20A (U) | NT40-CT20A-70 (U) | U5/8-11 | MC20-6, 8, 10, 12, 16 (1pc each) | JA20-JT6 (1pc) |
| 0710 06004020 | NT40 -CT20A (M) | NT40-CT20A-70 (M) | M16 P=2 | MC20-6, 8, 10, 12, 16 (1pc each) | JA20-JT6 (1pc) |
| 0710 05004032 | NT40 -CT32A (U) | NT40-CT32A-75 (U) | U5/8-11 | MC32-6, 8, 10, 12, 16, 20, 25 (1pc each) | — |
| 0710 06004032 | NT40 -CT32A (M) | NT40-CT32A-75 (M) | M16 P=2 | MC32-6, 8, 10, 12, 16, 20, 25 (1pc each) | — |
| 0710 05005032 | NT50 -CT32A (U) | NT50-CT32A-85 (U) | U1-8 | MC32-6, 8, 10, 12, 16, 20, 25 (1pc each) | JA32-JT6 (1pc) |
| 0710 06005032 | NT50 -CT32A (M) | NT50-CT32A-85 (M) | M24 P=3 | MC32-6, 8, 10, 12, 16, 20, 25 (1pc each) | JA32-JT6 (1pc) |
| 0710 05005042 | NT50 -CT42A (U) | NT50-CT42A-85 (U) | U1-8 | MC42-6, 8, 10, 12, 16, 20, 25, 32 (1pc each) | JA42-JT6 (1pc) |
| 0710 06005042 | NT50 -CT42A (M) | NT50-CT42A-85 (M) | M24 P=3 | MC42-6, 8, 10, 12, 16, 20, 25, 32 (1pc each) | JA42-JT6 (1pc) |

Ordering Example

NT40 - CT 32 A (U)

Shank size

I.D. (d)

Draw-bolt