

MTA

Morse Taper Holder

- For Morse taper shank with tang.

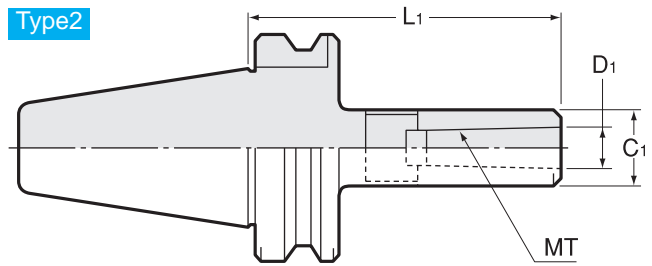
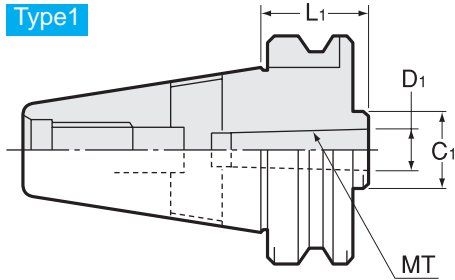

Metric Sizes

Unit : Metric

Code	Model	Type	MT	L1	D1	C1	kg
0760 00101045	BT30 -MTA1 -45	1	1	45	12.065	25	0.5
0760 00102060	BT30 -MTA2 -60	1	2	60	17.780	32	0.5
0760 00103075	BT30 -MTA3 -75	1	3	75	23.825	40	0.7
0760 00301045	BT40 -MTA1 -45	1	1	45	12.065	25	1.0
0760 00301120	-120	2	1	120	12.065	25	1.3
0760 00302045	BT40 -MTA2 -45	1	2	45	17.780	32	1.0
0760 00302120	-120	2	2	120	17.780	32	1.4
0760 00303075	BT40 -MTA3 -75	1	3	75	23.825	40	1.2
0760 00303135	-135	2	3	135	23.825	40	1.8
0760 00304090	BT40 -MTA4 -90	1	4	90	31.267	50	1.4
0760 00304165	-165	2	4	165	31.267	50	2.4
0760 00501045	BT50 -MTA1 -45	1	1	45	12.065	25	3.6
0760 00501120	-120	2	1	120	12.065	25	3.8
0760 00501180	-180	2	1	180	12.065	25	3.9
0760 00502045	BT50 -MTA2 -45	1	2	45	17.780	32	3.6
0760 00502135	-135	2	2	135	17.780	32	4.0
0760 00502180	-180	2	2	180	17.780	32	4.2
0760 00503045	BT50 -MTA3 -45	1	3	45	23.825	40	3.5
0760 00503150	-150	2	3	150	23.825	40	4.3
0760 00503180	-180	2	3	180	23.825	40	4.5
0760 00504075	BT50 -MTA4 -75	1	4	75	31.267	50	3.6
0760 00504180	-180	2	4	180	31.267	50	5.0
0760 00505105	BT50 -MTA5 -105	1	5	105	44.399	65	3.9
0760 00505210	-210	2	5	210	44.399	65	6.3

Ordering Example

BT30 - MTA1 - 45

Shank size MT1 Projection length (L)

Morse Taper Holder

- For Morse taper shank with tang.

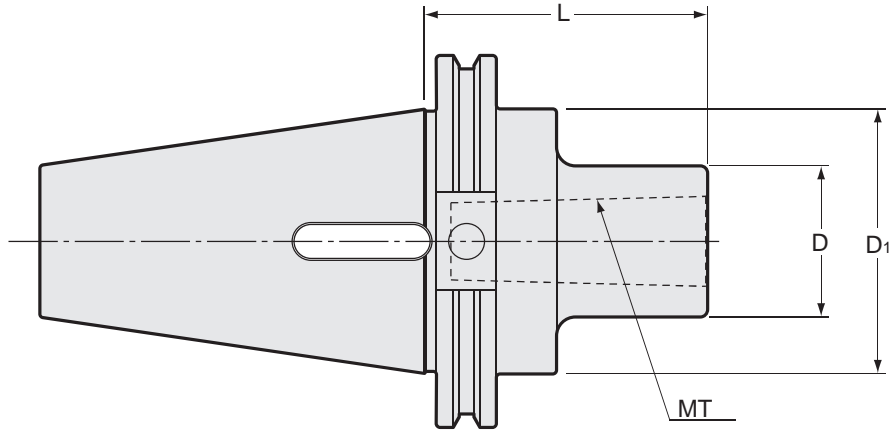

Unit : Inch

Code	Model	MT	L	D	D1	kg
1930 00401045	CAT40 MTA1 -45	1	1.770	1.000	1.750	
1930 00402060	CAT40 MTA2 -60	2	2.360	1.260	1.750	
1930 00403075	CAT40 MTA3 -75	3	3.000	1.570	1.750	
1930 00404090	CAT40 MTA4 -90	4	3.540	1.970	1.750	
1930 00502060	CAT50 MTA2 -60	2	2.360	1.260	2.750	3.1
1930 00503075	CAT50 MTA3 -75	3	3.000	1.570	2.750	3.2
1930 00504090	CAT50 MTA4 -90	4	3.540	1.970	2.750	3.3
1930 00505105	CAT50 MTA5 -105	5	4.130	2.760	2.750	

Ordering Example

CAT40 - MTA1 - 45

Shank size

MT

Projection length (L)

MTA

Morse Taper Holder

- For Morse taper shank with tang.

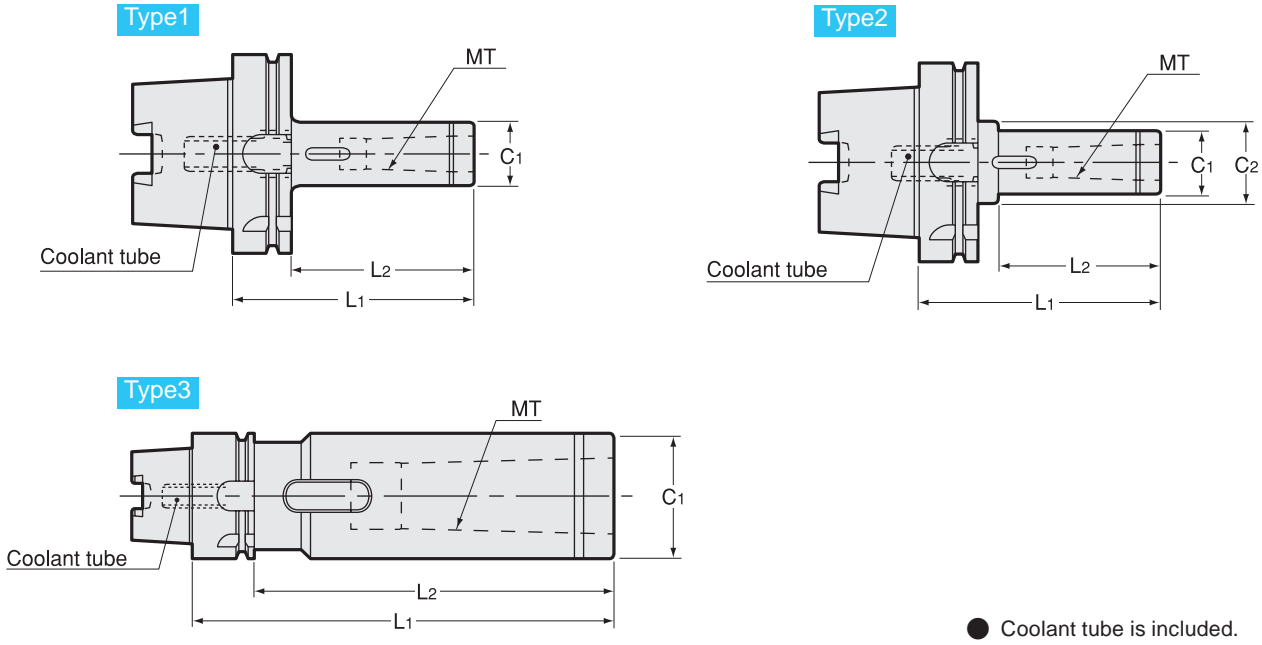

Metric Sizes									Unit : Metric
Code	Model	Type	MT	L1	C1	L2	C2	kg	
5400 13001090	HSK40A -MTA1 -90	1	1	90	25	70	—		
5400 13002105	HSK40A -MTA2 -105	1	2	105	32	85	—		
5400 13003135	HSK40A -MTA3 -135	3	3	135	40	115	—	0.98	
5400 14001095	HSK50A -MTA1 -95	1	1	95	25	69	—		
5400 14002110	HSK50A -MTA2 -110	1	2	110	32	84	—		
5400 14003135	HSK50A -MTA3 -135	1	3	135	40	109	—		
5400 15001105	HSK63A -MTA1 -105	1	1	105	25	79	—		
5400 15002120	HSK63A -MTA2 -120	1	2	120	32	94	—		
5400 15003150	HSK63A -MTA3 -150	1	3	150	40	124	—		
5400 15004165	HSK63A -MTA4 -165	1	4	165	50	139	—		
5400 17001105	HSK100A -MTA1 -105	2	1	105	25	66	32	2.3	
5400 17002120	HSK100A -MTA2 -120	1	2	120	32	91	—		
5400 17003135	HSK100A -MTA3 -135	1	3	135	40	106	—		
5400 17004165	HSK100A -MTA4 -165	1	4	165	50	136	—		
5400 17005195	HSK100A -MTA5 -195	1	5	195	65	166	—		

Ordering Example

HSK63A - MTA1 - 105
 Shank size MT Projection length (L)