

STM

Synchronous Tap Holder With Easy Tool Length Adjustment

- Projection length of the cutting tool can be adjusted by simply turning circumference of the holder.

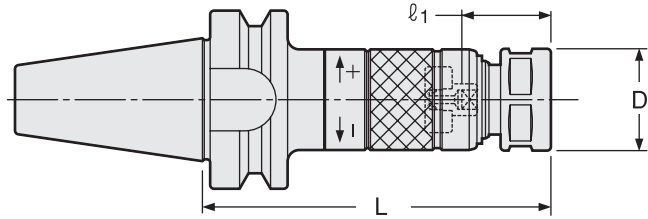

! For capable tap sizes, please refer to P.462-464 chart.

(NOTE) Nut O.D. of STM8 is 19mm.

STM Holder + Collet + STS Driver

Unit : Metric

Code	Model	Tap Size	L	D	Nut	kg	Collet	Preset Driver	Spanner
3910 00100075	BT30 -STM8 -75 *	Old JIS Taps	75	21	KDP-1414		FDC-07	STS-8	Flat 17mm width
3910 00100090		M4 ~ 8	90	21	KDP-1414				
3910 00100105		-105	105	21	KDP-1414				
3910 00100120		-120	120	21	KDP-1414				
3910 00100135		-135	135	21	KDP-1414				
3910 00100150	-150	150	21	KDP-1414					
3910 10100075	BT30 -STM12 -75 *	Old JIS Taps	75	26	HTP-09	0.6	FSC-09	STS-12	S-1L
3910 10100090		M4 ~ 12	90	26	HTP-09	0.6			
3910 10100105		-105	105	26	HTP-09	0.7			
3910 10100120		-120	120	26	HTP-09	0.7			
3910 10100135		-135	135	26	HTP-09	0.8			
3910 10100150	-150	150	26	HTP-09	0.8				
3910 10100165	-165	165	26	HTP-09					
3910 30100090	BT30 -STM18 -90	Old JIS Taps	90	36	HTP-16	0.7	FSC-16	STS-18	S-4L
3910 30100105		M14 ~ 18	105	36	HTP-16	0.8			
3910 30100120		-120	120	36	HTP-16				
3910 30100135		-135	135	36	HTP-16				
3910 30100150		-150	150	36	HTP-16				
3910 30100165	-165	165	36	HTP-16					
3910 40100105	BT30 -STM30 -105	Old JIS Taps	105	46	HTP-22		FSC-22	STS-30	S-5L
3910 40100120		M20 ~ 30	120	46	HTP-22	1.2			
3910 40100135		-135	135	46	HTP-22				
3910 40100150		-150	150	46	HTP-22				
3910 40100165		-165	165	46	HTP-22				
3910 00300090	BT40 -STM8 -90	Old JIS Taps	90	21	KDP-1414	1.1	FDC-07	STS-8	Flat 17mm width
3910 00300105		M4 ~ 8	105	21	KDP-1414	1.1			
3910 00300120		-120	120	21	KDP-1414	1.2			
3910 00300135		-135	135	21	KDP-1414	1.2			
3910 00300150		-150	150	21	KDP-1414	1.2			
3910 10300090	BT40 -STM12 -90	Old JIS Taps	90	26	HTP-09	1.2	FSC-09	STS-12	S-1L
3910 10300105		M4 ~ 12	105	26	HTP-09	1.2			
3910 10300120		-120	120	26	HTP-09	1.2			
3910 10300135		-135	135	26	HTP-09	1.3			
3910 10300150		-150	150	26	HTP-09	1.3			
3910 10300180	-180	180	26	HTP-09	1.4				
3910 30300105	BT40 -STM18 -105	Old JIS Taps	105	36	HTP-16	1.4	FSC-16	STS-18	S-4L
3910 30300120		M14 ~ 18	120	36	HTP-16	1.5			
3910 30300135		-135	135	36	HTP-16	1.6			
3910 30300150		-150	150	36	HTP-16	1.7			
3910 30300180		-180	180	36	HTP-16				
3910 40300120	BT40 -STM30 -120	Old JIS Taps	120	46	HTP-22	1.7	FSC-22	STS-30	S-5L
3910 40300135		M20 ~ 30 U7/8 ~ 1-1/8 PT1/2 ~ 3/4	135	46	HTP-22	1.8			
3910 40300150		-150	150	46	HTP-22				
3910 40300180		-180	180	46	HTP-22	2.4			
3910 00500090		BT50 -STM8 -90 *	Old JIS Taps	90	21	KDP-1414			
3910 00500105	M4 ~ 8		105	21	KDP-1414				
3910 00500120	-120		120	21	KDP-1414				
3910 00500135	-135		135	21	KDP-1414				
3910 00500150	-150		150	21	KDP-1414				
3910 00500165	-165	165	21	KDP-1414					
3910 10500090	BT50 -STM12 -90 *	Old JIS Taps	90	26	HTP-09		FSC-09	STS-12	S-1L
3910 10500105		M4 ~ 12	105	26	HTP-09				
3910 10500120		-120	120	26	HTP-09				
3910 10500135		-135	135	26	HTP-09				
3910 10500150		-150	150	26	HTP-09	3.9			
3910 10500180	-180	180	26	HTP-09					

Code	Model	Tap Size	L	D	Nut	kg	Collet	Preset Driver	Spanner
3910 30500105	BT50 -STM18 -105	Old JIS Taps	105	36	HTP-16		FSC-16	STS-18	S-4L
3910 30500120		M14 ~ 18	120	36	HTP-16				
3910 30500135		U1/2 ~ 3/4 PT1/4 ~ 3/8	135	36	HTP-16				
3910 30500150		OSG Synchro Tap	150	36	HTP-16				
3910 30500180		M12 ~ 14	180	36	HTP-16				
3910 40500120	BT50 -STM30 -120	Old JIS Taps	120	46	HTP-22		FSC-22	STS-30	S-5L
3910 40500135		M20 ~ 30	135	46	HTP-22				
3910 40500150		U7/8 ~ 1-1/8 PT1/2 ~ 3/4	150	46	HTP-22	4.4			
3910 40500180		OSG Synchro Taps	180	46	HTP-22				
3910 40500210		M16 ~ 27	210	46	HTP-22				

- Collet, spanner and preset driver are sold separately.
- Please see below for $\ell 1$ dimension.
- Tap holes smaller than M4 can be made by STM8. Collets to be used are as follows.
M1-M2.6: FDC-03007-*** M3-M3.5: FDC-04007-***
Tap drive will not be used for the above usages.

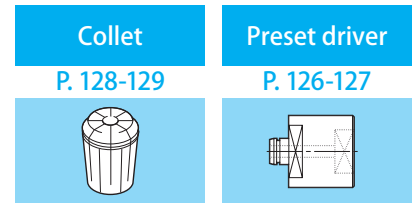

Ordering Example

BT50 - STM 18 - 120
 Shank size Holder size Projection length (L)

$\ell 1$ Dimension for STM

Old JIS Taps

Without center-through coolant			With center-through coolant (STM)		
Tap Size	$\ell 1$	$\ell 1(*)$	Tap Size	$\ell 1$	$\ell 1(*)$
M4 ~ 6 U No.8 ~ 1/4	21 ~ 35	21 ~ 26	M4 ~ 6 U No.8 ~ 1/4	24 ~ 35	24 ~ 26
M7 ~ 12 U 5/16 ~ U7/16 PT1/8	23 ~ 37	23 ~ 28	M7 ~ 10 U 5/16 ~ 3/8	25 ~ 37	25 ~ 28
M13 ~ 15 U 1/2 ~ 5/8 PT1/4	28 ~ 42	-	M11 ~ 12 U 7/16 PT 1/8	26 ~ 37	26 ~ 28
M16 ~ 17	32 ~ 45	-	U1/2	32 ~ 42	-
M18 ~ 27 U 3/4 ~ U1 PT3/8 ~ 5/8	33 ~ 47	-	M13 ~ 15 U9/16	33 ~ 42	-
M30 U1-1/8 PT3/4	38 ~ 52	-	U5/8 PT1/4	34 ~ 42	-
			M16	35 ~ 46	-
			M18 U 3/4 PT3/8	36 ~ 47	-
			M20 ~ 21 PT1/2	40 ~ 47	-
			M22 U 7/8	41 ~ 47	-
			M23	42 ~ 47	-
			M24 ~ 25 PT5/8	43 ~ 47	-
			M26 ~ 27 U1	44 ~ 47	-
			M28	45 ~ 52	-
			M30 PT3/4	46 ~ 52	-
			U 1-1/8	48 ~ 52	-

OSG Synchro Taps

Without center-through coolant			With center-through coolant (STM8)			With center-through coolant (STM12 ~ 30)		
Tap Size	$\ell 1$	$\ell 1(*)$	Tap Size	$\ell 1$	$\ell 1(*)$	Tap Size	$\ell 1$	$\ell 1(*)$
M4 ~ 6	21 ~ 35	21 ~ 26	M4 ~ 6	25 ~ 35	25 ~ 26	M4 ~ 6	24 ~ 35	24 ~ 26
M8 ~ 10	23 ~ 37	23 ~ 28	M7 ~ 8 U5/16	26 ~ 37	26 ~ 28	M8 ~ 10	26 ~ 37	26 ~ 28
M12 ~ 14	28 ~ 42	-				M12	33 ~ 42	-
M16 ~ 27	33 ~ 47	-				M14	34 ~ 42	-
						M16 ~ 20	40 ~ 46	-
						M22 ~ 27	44 ~ 47	-

YAMAWA X Series

Without center-through coolant			With center-through coolant (STM8)			With center-through coolant (STM12 ~ 30)		
Tap Size	$\ell 1$	$\ell 1(*)$	Tap Size	$\ell 1$	$\ell 1(*)$	Tap Size	$\ell 1$	$\ell 1(*)$
M6 M8	23 ~ 37	23 ~ 28	M6	26 ~ 37	26 ~ 28	M6	25 ~ 37	25 ~ 28
M10 M12	28 ~ 42	-				M8	26 ~ 37	26 ~ 28
						M10	33 ~ 42	-
						M12	34 ~ 42	-

Tap size reference chart (collet, preset driver)

FDC-07 or FSC - collet

preset driver & tool for changing driver

OH Type

● OH type collet should be used for center-through coolant feeding and external coolant feeding.

C Type

● when "collet-through" coolant feeding is needed.

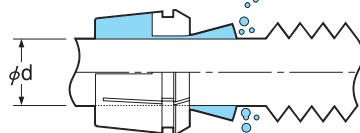
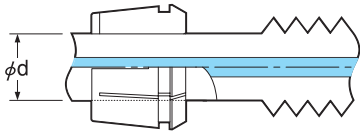

STS Type

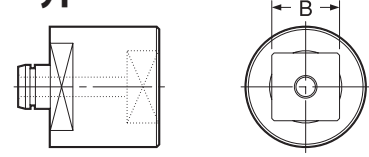

STS-R Type

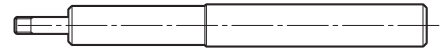

※ Please select OH type for non-coolant use.

Holder Model	Tap Size					ød	Collet Model (OH or C)	B	Preset Driver	Tool for Changing Driver
	Metric Thread	Unified Thread	Pipe Taper Thread	OSG Synchro-Taps	YAMAWA X Series					
STM8	M4~M4.5	UNo.8				5.0	FDC-05007-**	4.0	STS8-□4.0	STS-R0
	M5~M5.5	UNo.10~12				5.5	FDC-05507-**	4.5	STS8-□4.5	STS-R0
	M6	U1/4		M4~M6		6.0	FDC-06007-**	4.5	STS8-□4.5	STS-R0
		U5/16			M6	6.0	FDC-06007-**	4.9	STS8-□4.9	STS-R0
	M7~8					6.1	FDC-06107-**	5.0	STS8-□5.0	STS-R0
					6.2	FDC-06207-**	5.0	STS8-□5.0	STS-R0	
STM12	M4~M4.5	UNo.8				5.0	FSC-09-5.0-**	4.0	STS12-□4.0	STS-R1
	M5~M5.5	UNo.10~12				5.5	FSC-09-5.5-**	4.5	STS12-□4.5	STS-R1
	M6	U1/4		M4~M6		6.0	FSC-09-6.0-**	4.5	STS12-□4.5	STS-R1
		U5/16			M6	6.0	FSC-09-6.0-**	4.9	STS12-□4.9	STS-R1
	M7~8					6.1	FSC-09-6.1-**	5.0	STS12-□5.0	STS-R1
	M9~M10	U3/8				7.0	FSC-09-7.0-**	5.5	STS12-□5.5	STS-R1
					M8	8.0	FSC-09-8.0-**	6.2	STS12-□6.2	STS-R1
	M11	U7/16	PT1/16~1/8	M8~M10		8.0	FSC-09-8.0-**	6.0	STS12-□6.0	STS-R1
	M12					8.5	FSC-09-8.5-**	6.5	STS12-□6.5	STS-R1
		U1/2				9.0	FSC-16-9.0-**	7.0	STS18-□7.0	STS-R2
STM18	M13					9.5	FSC-16-9.5-**	7.0	STS18-□7.0	STS-R2
				M12	M10	10.0	FSC-16-10.0-**	8.0	STS18-□8.0	STS-R2
	M14~15	U9/16				10.5	FSC-16-10.5-**	8.0	STS18-□8.0	STS-R2
			PT1/4			11.0	FSC-16-11.0-**	9.0	STS18-□9.0	STS-R2
		U5/8		M14	M12	12.0	FSC-16-12.0-**	9.0	STS18-□9.0	STS-R2
	M16					12.5	FSC-16-12.5-**	10.0	STS18-□10.0	STS-R2
	M17					13.0	FSC-16-13.0-**	10.0	STS18-□10.0	STS-R2
	M18~M19	U3/4	PT3/8			14.0	FSC-16-14.0-**	11.0	STS18-□11.0	STS-R2
STM30	M20					15.0	FSC-22-15.0-**	12.0	STS30-□12.0	STS-R2
	M21			M16~M20		16.0	FSC-22-16.0-**	12.0	STS30-□12.0	STS-R2
	M22	U7/8				17.0	FSC-22-17.0-**	13.0	STS30-□13.0	STS-R2
	M23		PT1/2			18.0	FSC-22-18.0-**	14.0	STS30-□14.0	STS-R2
	M24~M25		PT5/8			19.0	FSC-22-19.0-**	15.0	STS30-□15.0	STS-R2
	M26~M27	U1		M22~M27		20.0	FSC-22-20.0-**	15.0	STS30-□15.0	STS-R2
	M28					21.0	FSC-22-21.0-**	17.0	STS30-□17.0	STS-R2
		U1-1/8				22.0	FSC-22-22.0-**	17.0	STS30-□17.0	STS-R2
						23.0	FSC-22-23.0-**	17.0	STS30-□17.0	STS-R2
	M30		PT3/4							

Ordering Example

FSC - 22 - 20.0 - OH

Collet size

Collet I.D. (d)

OH: for tool with coolant hole
C: for collet through

Combination of accessories

Tap holder	Collet	Preset driver		Nut		Tool changing driver		Spanner	
Model	Model	Model	Code	Model	Code	Model	Code	Model	Code
STM8	FDC-07	STS8	3914 0100**03	KDP-1414	0070 01001407	STS-R0	3914 00000006	Flat 17mm width	
STM12	FSC-09	STS12	3914 1100**03	HTP-09	1314 00000009	STS-R1	3914 10000006	S-1L	0803 00000011
STM18	FSC-16	STS18	3914 310**03	HTP-16	1314 00000016	STS-R2	3914 30000006	S-4L	0803 00000014
STM30	FSC-22	STS30	3914 410**03	HTP-22	1314 00000022	STS-R2	3914 30000006	S-5L	0803 00000015

Tap size reference chart (collet, preset driver)

FDC-07 or FSC - collet

preset driver & tool for changing driver

OH Type

● OH type collet should be used for center-through coolant feeding and external coolant feeding.

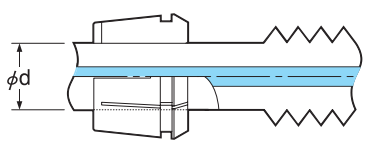

C Type

● when "collet-through" coolant feeding is needed.

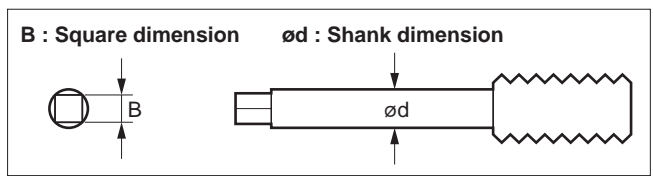
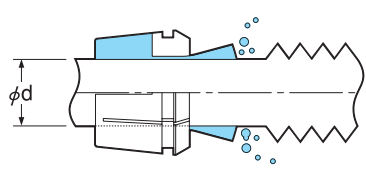

STS Type

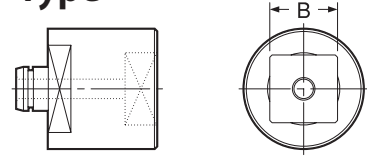

STS-R Type

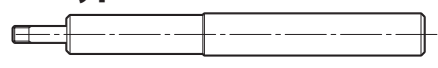

※ Please select OH type for non-coolant use.

Holder Model	Tap Size (ANSI)	ød (inch)	ød (mm)	Collet Model (OH or C)	B (inch)	B (mm)	Preset Driver
STM8	#0-6	0.141	3.5814	FDC-03607**	0.110	2.794	STS8- □ 2.8
	#8	0.168	4.2672	FDC-04307**	0.131	3.3274	STS8- □ 3.4
	#10	0.194	4.9276	FDC-05007**	0.152	3.8608	STS8- □ 4.0
	#12	0.22	5.588	FDC-05607**	0.165	4.191	STS8- □ 4.2
	1/4	0.255	6.477	FDC-06507**	0.191	4.8514	STS8- □ 5.0
STM12	#0-6	0.141	3.5814	FSC-09-3.6**	0.110	2.794	STS12- □ 2.8
	#8	0.168	4.2672	FSC-09-4.3**	0.131	3.3274	STS12- □ 3.4
	#10	0.194	4.9276	FSC-09-5.0**	0.152	3.8608	STS12- □ 4.0
	#12	0.22	5.588	FSC-09-5.6**	0.165	4.191	STS12- □ 4.2
	1/4	0.255	6.477	FSC-09-6.5**	0.191	4.8514	STS12- □ 5.0
	1/8SPT	0.313	7.9502	FSC-09-8.0**	0.234	5.9436	STS12- □ 6.0
	5/16	0.318	8.0772	FSC-09-8.1**	0.238	6.0452	STS12- □ 6.1
7/16	0.323	8.2042	FSC-09-8.3**	0.242	6.1468	STS12- □ 6.2	
STM18	1/2	0.367	9.3218	FSC-16-9.4**	0.275	6.985	STS18- □ 7.0
	3/8	0.381	9.6774	FSC-16-9.7**	0.286	7.2644	STS18- □ 7.3
	9/16	0.429	10.8966	FSC-16-10.9**	0.322	8.1788	STS18- □ 8.2
	1/8LPT	0.437	11.0998	FSC-16-11.1**	0.328	8.3312	STS18- □ 8.4
	5/8	0.48	12.192	FSC-16-12.2**	0.360	9.144	STS18- □ 9.2
	11/16	0.542	13.7668	FSC-16-13.8**	0.406	10.3124	STS18- □ 10.4
	1/4PT	0.562	14.2748	FSC-16-14.3**	0.421	10.6934	STS18- □ 10.7
STM30	3/4	0.59	14.986	FSC-22-15.0**	0.442	11.2268	STS30- □ 11.3
	13/16	0.652	16.5608	FSC-22-16.6**	0.489	12.4206	STS30- □ 12.5
	7/8	0.697	17.7038	FSC-22-17.8**	0.523	13.2842	STS30- □ 13.3
	3/8PT	0.7	17.78	FSC-22-17.8**	0.531	13.4874	STS30- □ 13.5
	1	0.8	20.32	FSC-22-20.4**	0.600	15.24	STS30- □ 15.3

For DIN and ISO, please refer to P.463-464.

Ordering Example

FSC - 22 - 20.4 - OH

Collet size Collet I.D. (d) OH: for tool with coolant hole
C: for collet through

Combination of accessories

Tap holder	Collet	Preset driver		Nut		Tool changing driver		Spanner	
Model	Model	Model	Code	Model	Code	Model	Code	Model	Code
STM8	FDC-07	STS8	3914 0100**03	KDP-1414	0070 01001407	STS-R0	3914 00000006	Flat 17mm width	
STM12	FSC-09	STS12	3914 1100**03	HTP-09	1314 00000009	STS-R1	3914 10000006	S-1L	0803 00000011
STM18	FSC-16	STS18	3914 310**03	HTP-16	1314 00000016	STS-R2	3914 30000006	S-4L	0803 00000014
STM30	FSC-22	STS30	3914 410**03	HTP-22	1314 00000022	STS-R2	3914 30000006	S-5L	0803 00000015



BT
CAT
AHO
HSK-A/E/F/C
HSK-T
UTS
Specialized Machine
Related Equipment
Bush & Chamfering Drill
Milling Chuck
Collet Holder
"R" Zero Holder
Hydraulic Chuck
Shrink Fit
Tapping Chuck
Arbors
Function Holder
Turning Tool
Retention Stud
Tool Shank Dimensions

STM

Synchronous Tap Holder With Easy Tool Length Adjustment

- Projection length of the cutting tool can be adjusted by simply turning circumference of the holder.

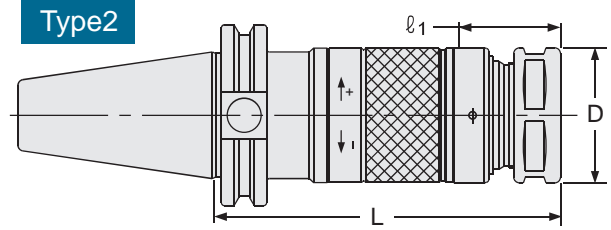
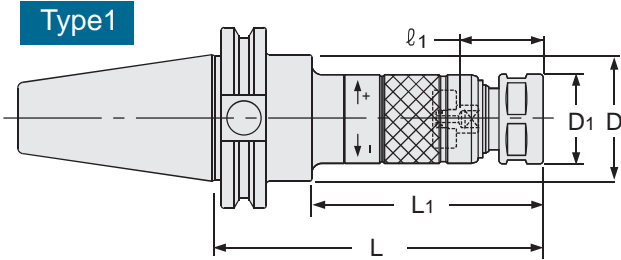

⚠ For capable tap sizes, please refer to P.462-464 chart.

(NOTE) Nut O.D. of STM8 is 0.748".

STM Holder + Collet + STS Driver

Unit : Inch

Code	Model	Type	Tap Size	L	L1	D	D1	kg	Nut	Collet	Preset Driver	Spanner
1880 00400090	CAT40 -STM8 -90 *	1		3.543	2.126	1.752	0.827					
1880 00400105	-105	1	Old JIS Taps	4.134	2.717	1.752	0.827	1.1	KDP-1414	FDC-07	STS-8	Flat 17mm width
1880 00400120	-120	1	M4-8 U No8-5/16	4.724	3.307	1.752	0.827	1.2				
1880 00400135	-135	1	OSG Synchro Taps	5.315	4.291	1.752	0.827	1.2				
1880 00400150	-150	1	M4-6	5.906	4.882	1.752	0.827					
1880 10400090	CAT40 -STM12 -90 *	1		3.543	2.126	1.752	1.024	1.2	HTP-09	FSC-09	STS-12	S-1L
1880 10400105	-105	1	Old JIS Taps	4.134	2.717	1.752	1.024	1.2				
1880 10400120	-120	1	M4-12 U No8-7/16	4.724	3.307	1.752	1.024	1.2				
1880 10400135	-135	1	PT1/8	5.315	4.291	1.752	1.024	1.3				
1880 10400150	-150	1	OSG Synchro Taps	5.906	4.882	1.752	1.024					
1880 10400180	-180	1	M4-10	7.087	6.063	1.752	1.024					
1880 30400105	CAT40 -STM18 -105	1		4.134	2.717	1.752	1.417	1.3	HTP-16	FSC-16	STS-18	S-4L
1880 30400120	-120	1	Old JIS Taps	4.724	3.307	1.752	1.417	1.4				
1880 30400135	-135	1	M14-18 U1/2-3/4	5.315	4.291	1.752	1.417	1.5				
1880 30400150	-150	1	PT1/4-3/8	5.906	4.882	1.752	1.417					
1880 30400180	-180	1	OSG Synchro Taps	7.087	6.063	1.752	1.417					
1880 40400120	CAT40 -STM30 -120	2		4.724	—	1.811	—	1.6	HTP-22	FSC-22	STS-30	S-5L
1880 40400135	-135	2	Old JIS Taps	5.315	—	1.811	—	1.8				
1880 40400150	-150	2	M20-30 U7/8-1-1/8	5.906	—	1.811	—	1.9				
1880 40400180	-180	2	PT1/2-3/4	7.087	—	1.811	—					
1880 00500090	CAT50 -STM8 -90 *	1		3.543	2.126	2.752	0.827		KDP-1414	FDC-07	STS-8	Flat 17mm width
1880 00500105	-105	1	Old JIS Taps	4.134	2.717	2.752	0.827	3.1				
1880 00500120	-120	1	M4-8 U No8-5/16	4.724	3.307	2.752	0.827	3.1				
1880 00500135	-135	1	OSG Synchro Taps	5.315	4.291	2.752	0.827	3.2				
1880 00500150	-150	1	M4-6	5.906	4.882	2.752	0.827					
1880 00500165	-165	1		6.496	5.472	2.752	0.827					
1880 10500090	CAT50 -STM12 -90 *	1		3.543	2.126	2.752	1.024		HTP-09	FSC-09	STS-12	S-1L
1880 10500105	-105	1	Old JIS Taps	4.134	2.717	2.752	1.024	3.2				
1880 10500120	-120	1	M4-12 U No8-7/16	4.724	3.307	2.752	1.024	3.2				
1880 10500135	-135	1	PT1/8	5.315	4.291	2.752	1.024	3.3				
1880 10500150	-150	1	OSG Synchro Taps	5.906	4.882	2.752	1.024					
1880 10500180	-180	1	M4-10	7.087	6.063	2.752	1.024	3.4				
1880 30500105	CAT50 -STM18 -105	1		4.134	2.717	2.752	1.417	3.3	HTP-16	FSC-16	STS-18	S-4L
1880 30500120	-120	1	Old JIS Taps	4.724	3.307	2.752	1.417	3.4				
1880 30500135	-135	1	M14-18 U1/2-3/4	5.315	4.291	2.752	1.417	3.5				
1880 30500150	-150	1	PT1/4-3/8	5.906	4.882	2.752	1.417					
1880 30500180	-180	1	OSG Synchro Taps	7.087	6.063	2.752	1.417	3.8				
1880 40500120	CAT50 -STM30 -120	1		4.724	3.307	2.752	1.811	3.5	HTP-22	FSC-22	STS-30	S-5L
1880 40500135	-135	1	Old JIS Taps	5.315	4.291	2.752	1.811	3.7				
1880 40500150	-150	1	M20-30 U7/8-1-1/8	5.906	4.882	2.752	1.811	3.9				
1880 40500180	-180	1	PT1/2-3/4	7.087	6.063	2.752	1.811					
1880 40500210	-210	1	OSG Synchro Taps	8.268	7.244	2.752	1.811					

1. Collet, spanner and preset driver are sold separately.
2. Please see next page for l_1 dimension.
3. Tap holes smaller than M4 can be made by STM8. Collets to be used are as follows.
M1-M2.6: FDC-03007- ※※ M3-M3.5: FDC-04007- ※※
Tap drive will not be used for the above usages.

Ordering Example

CAT40 - STM 8 - 90
 Shank size Holder size Projection length (L)

Ø1 Dimension for STM

Old JIS Taps (Unit : Inch)

Without center-through coolant			With center-through coolant (STM12 ~ 30)		
Tap Size	ℓ1	ℓ1(*)	Tap Size	ℓ1	ℓ1(*)
M4 ~ 6 U No.8 ~ 1/4	0.82 ~ 1.37	0.82 ~ 1.02	M4 ~ 6 U No.8 ~ 1/4	0.94 ~ 1.37	0.94 ~ 1.02
M7 ~ 12 U 5/16 ~ U7/16 PT1/8	0.90 ~ 1.45	0.90 ~ 1.10	M7 ~ 10 U 5/16 ~ 3/8	0.98 ~ 1.45	0.98 ~ 1.10
M13 ~ 15 U 1/2 ~ 5/8 PT1/4	1.10 ~ 1.65	—	M11 ~ 12 U 7/16 PT 1/8	1.02 ~ 1.45	1.02 ~ 1.10
M16 ~ 17	1.25 ~ 1.77	—	U1/2	1.25 ~ 1.65	—
M18 ~ 27 U 3/4 ~ U1 PT3/8 ~ 5/8	1.29 ~ 1.85	—	M13 ~ 15 U9/16	1.29 ~ 1.65	—
M30 U1-1/8 PT3/4	1.49 ~ 2.04	—	U5/8 PT1/4	1.33 ~ 1.65	—
With center-through coolant (STM8)			M16	1.37 ~ 1.81	—
Tap Size	ℓ1	ℓ1(*)	M18 U 3/4 PT3/8	1.41 ~ 1.85	—
M4 ~ 6 U No.8 ~ 1/4	0.98 ~ 1.37	0.98 ~ 1.02	M20 ~ 21 PT1/2	1.57 ~ 1.85	—
M7 ~ 8 U5/16	1.02 ~ 1.45	1.02 ~ 1.10	M22 U 7/8	1.61 ~ 1.85	—
			M23	1.65 ~ 1.85	—
			M24 ~ 25 PT5/8	1.69 ~ 1.85	—
			M26 ~ 27 U1	1.73 ~ 1.85	—
			M28	1.77 ~ 2.04	—
			M30 PT3/4	1.81 ~ 2.04	—
			U 1-1/8	1.88 ~ 2.04	—

OSG Synchro Taps (Unit : Inch)

Without center-through coolant		
Tap Size	ℓ1	ℓ1(*)
M4 ~ 6	0.82 ~ 1.37	0.82 ~ 1.02
M8 ~ 10	0.90 ~ 1.45	0.90 ~ 1.10
M12 ~ 14	1.10 ~ 1.65	—
M16 ~ 27	1.29 ~ 1.85	—

With center-through coolant (STM8)		
Tap Size	ℓ1	ℓ1(*)
M4 ~ 6	0.98 ~ 1.37	0.98 ~ 1.02

With center-through coolant (STM12 ~ 30)		
Tap Size	ℓ1	ℓ1(*)
M4 ~ 6	0.94 ~ 1.37	0.94 ~ 1.02
M8 ~ 10	1.02 ~ 1.45	1.02 ~ 1.10
M12	1.29 ~ 1.65	—
M14	1.33 ~ 1.65	—
M16 ~ 20	1.57 ~ 1.81	—
M22 ~ 27	1.73 ~ 1.85	—

YAMAWA X Series (Unit : Inch)

Without center-through coolant		
Tap Size	ℓ1	ℓ1(*)
M6 M8	0.90 ~ 1.45	0.90 ~ 1.10
M10 M12	1.10 ~ 1.65	—

With center-through coolant (STM8)		
Tap Size	ℓ1	ℓ1(*)
M6	1.02 ~ 1.45	1.02 ~ 1.10

With center-through coolant (STM12 ~ 30)		
Tap Size	ℓ1	ℓ1(*)
M6	0.98 ~ 1.45	0.98 ~ 1.10
M8	1.02 ~ 1.45	1.02 ~ 1.10
M10	1.29 ~ 1.65	—
M12	1.33 ~ 1.65	—

Collet

P. 226



Preset driver

P. 224-225

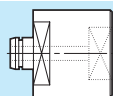

Tap size reference chart (collet, preset driver)

FDC-07 or FSC - collet

preset driver & tool for changing driver

OH Type

● OH type collet should be used for center-through coolant feeding and external coolant feeding.

C Type

● when "collet-through" coolant feeding is needed.

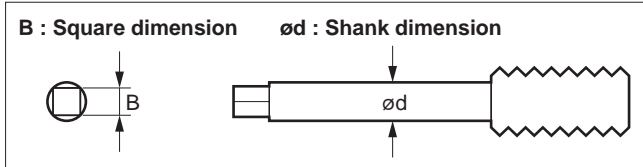
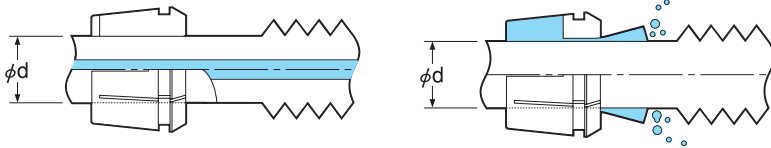

※ Please select OH type for non-coolant use.

STS Type

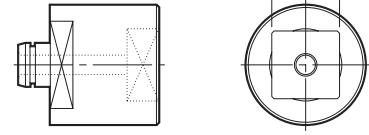

STS-R Type



Holder Model	Tap Size (ANSI)	ød (inch)	ød (mm)	Collet Model (OH or C)	B (inch)	B (mm)	Preset Driver
STM8	#0-6	0.141	3.5814	FDC-03607**	0.110	2.794	STS8-□ 2.8
	#8	0.168	4.2672	FDC-04307**	0.131	3.3274	STS8-□ 3.4
	#10	0.194	4.9276	FDC-05007**	0.152	3.8608	STS8-□ 4.0
	#12	0.22	5.588	FDC-05607**	0.165	4.191	STS8-□ 4.2
	1/4	0.255	6.477	FDC-06507**	0.191	4.8514	STS8-□ 5.0
STM12	#0-6	0.141	3.5814	FSC-09-3.6**	0.110	2.794	STS12-□ 2.8
	#8	0.168	4.2672	FSC-09-4.3**	0.131	3.3274	STS12-□ 3.4
	#10	0.194	4.9276	FSC-09-5.0**	0.152	3.8608	STS12-□ 4.0
	#12	0.22	5.588	FSC-09-5.6**	0.165	4.191	STS12-□ 4.2
	1/4	0.255	6.477	FSC-09-6.5**	0.191	4.8514	STS12-□ 5.0
	1/8SPT	0.313	7.9502	FSC-09-8.0**	0.234	5.9436	STS12-□ 6.0
	5/16	0.318	8.0772	FSC-09-8.1**	0.238	6.0452	STS12-□ 6.1
	7/16	0.323	8.2042	FSC-09-8.3**	0.242	6.1468	STS12-□ 6.2
STM18	1/2	0.367	9.3218	FSC-16-9.4**	0.275	6.985	STS18-□ 7.0
	3/8	0.381	9.6774	FSC-16-9.7**	0.286	7.2644	STS18-□ 7.3
	9/16	0.429	10.8966	FSC-16-10.9**	0.322	8.1788	STS18-□ 8.2
	1/8LPT	0.437	11.0998	FSC-16-11.1**	0.328	8.3312	STS18-□ 8.4
	5/8	0.48	12.192	FSC-16-12.2**	0.360	9.144	STS18-□ 9.2
	11/16	0.542	13.7668	FSC-16-13.8**	0.406	10.3124	STS18-□ 10.4
	1/4PT	0.562	14.2748	FSC-16-14.3**	0.421	10.6934	STS18-□ 10.7
STM30	3/4	0.59	14.986	FSC-22-15.0**	0.442	11.2268	STS30-□ 11.3
	13/16	0.652	16.5608	FSC-22-16.6**	0.489	12.4206	STS30-□ 12.5
	7/8	0.697	17.7038	FSC-22-17.8**	0.523	13.2842	STS30-□ 13.3
	3/8PT	0.7	17.78	FSC-22-17.8**	0.531	13.4874	STS30-□ 13.5
	1	0.8	20.32	FSC-22-20.4**	0.600	15.24	STS30-□ 15.3

For DIN and ISO, please refer to P.463-464.

Ordering Example

FSC - 22 - 20.4 - OH

Collet size

Collet I.D. (d)

OH: for tool with coolant hole
C: for collet through

Combination of accessories									
Tap holder	Collet	Preset driver		Nut		Tool changing driver		Spanner	
Model	Model	Model	Code	Model	Code	Model	Code	Model	Code
STM8	FDC-07	STS8	3914 0100**03	KDP-1414	0070 01001407	STS-R0	3914 00000006	Flat 17mm width	
STM12	FSC-09	STS12	3914 1100**03	HTP-09	1314 00000009	STS-R1	3914 10000006	S-1L	0803 00000011
STM18	FSC-16	STS18	3914 310**03	HTP-16	1314 00000016	STS-R2	3914 30000006	S-4L	0803 00000014
STM30	FSC-22	STS30	3914 410**03	HTP-22	1314 00000022	STS-R2	3914 30000006	S-5L	0803 00000015

Tap size reference chart (collet, preset driver)

FDC-07 or FSC - collet

preset driver & tool for changing driver

OH Type

● OH type collet should be used for center-through coolant feeding and external coolant feeding.

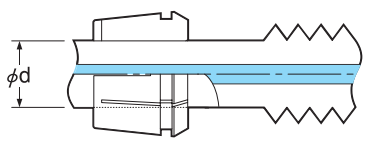

C Type

● when "collet-through" coolant feeding is needed.

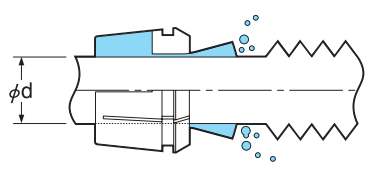

STS Type

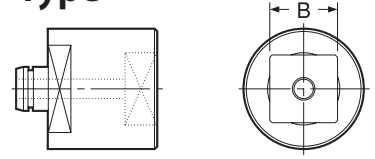

STS-R Type

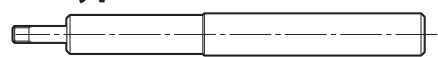

※ Please select OH type for non-coolant use.

Holder Model	Tap Size					ød	Collet Model (OH or C)	B	Preset Driver	Tool for Changing Driver	
	Metric Thread	Unified Thread	Pipe Taper Thread	OSG Synchro-Taps	YAMAWA X Series						
STM8	M4-M4.5	UNo.8				5.0	FDC-05007-**	4.0	STS8-□4.0	STS-R0	
	M5-M5.5	UNo.10~12				5.5	FDC-05507-**	4.5	STS8-□4.5	STS-R0	
	M6	U1/4		M4-M6		6.0	FDC-06007-**	4.5	STS8-□4.5	STS-R0	
					M6	6.0	FDC-06007-**	4.9	STS8-□4.9	STS-R0	
			U5/16			6.1	FDC-06107-**	5.0	STS8-□5.0	STS-R0	
	M7-8				6.2	FDC-06207-**	5.0	STS8-□5.0	STS-R0		
STM12	M4-M4.5	UNo.8				5.0	FSC-09-5.0-**	4.0	STS12-□4.0	STS-R1	
	M5-M5.5	UNo.10~12				5.5	FSC-09-5.5-**	4.5	STS12-□4.5	STS-R1	
	M6	U1/4		M4-M6		6.0	FSC-09-6.0-**	4.5	STS12-□4.5	STS-R1	
					M6	6.0	FSC-09-6.0-**	4.9	STS12-□4.9	STS-R1	
			U5/16			6.1	FSC-09-6.1-**	5.0	STS12-□5.0	STS-R1	
		M7-8				6.2	FSC-09-6.2-**	5.0	STS12-□5.0	STS-R1	
		M9-M10	U3/8			7.0	FSC-09-7.0-**	5.5	STS12-□5.5	STS-R1	
					M8	8.0	FSC-09-8.0-**	6.2	STS12-□6.2	STS-R1	
		M11	U7/16	PT1/16~1/8	M8-M10	8.0	FSC-09-8.0-**	6.0	STS12-□6.0	STS-R1	
	M12				8.5	FSC-09-8.5-**	6.5	STS12-□6.5	STS-R1		
STM18		U1/2				9.0	FSC-16-9.0-**	7.0	STS18-□7.0	STS-R2	
				M12	M10	9.5	FSC-16-9.5-**	7.0	STS18-□7.0	STS-R2	
						10.0	FSC-16-10.0-**	8.0	STS18-□8.0	STS-R2	
		M14-15	U9/16			10.5	FSC-16-10.5-**	8.0	STS18-□8.0	STS-R2	
				PT1/4		11.0	FSC-16-11.0-**	9.0	STS18-□9.0	STS-R2	
			U5/8		M14	M12	12.0	FSC-16-12.0-**	9.0	STS18-□9.0	STS-R2
		M16				12.5	FSC-16-12.5-**	10.0	STS18-□10.0	STS-R2	
		M17				13.0	FSC-16-13.0-**	10.0	STS18-□10.0	STS-R2	
STM30	M18-M19	U3/4	PT3/8			14.0	FSC-16-14.0-**	11.0	STS18-□11.0	STS-R2	
	M20					15.0	FSC-22-15.0-**	12.0	STS30-□12.0	STS-R2	
	M21			M16-M20		16.0	FSC-22-16.0-**	12.0	STS30-□12.0	STS-R2	
	M22	U7/8				17.0	FSC-22-17.0-**	13.0	STS30-□13.0	STS-R2	
	M23		PT1/2			18.0	FSC-22-18.0-**	14.0	STS30-□14.0	STS-R2	
	M24-M25		PT5/8			19.0	FSC-22-19.0-**	15.0	STS30-□15.0	STS-R2	
	M26-M27	U1		M22-M27		20.0	FSC-22-20.0-**	15.0	STS30-□15.0	STS-R2	
	M28					21.0	FSC-22-21.0-**	17.0	STS30-□17.0	STS-R2	
			U1-1/8			22.0	FSC-22-22.0-**	17.0	STS30-□17.0	STS-R2	
	M30		PT3/4		23.0	FSC-22-23.0-**	17.0	STS30-□17.0	STS-R2		

Ordering Example

FSC - 22 - 20.0 - OH

Collet size I.D. (d)

OH: for tool with coolant hole
C: for collet through

Combination of accessories

Tap holder	Collet	Preset driver		Nut		Tool changing driver		Spanner	
Model	Model	Model	Code	Model	Code	Model	Code	Model	Code
STM8	FDC-07	STS8	3914 0100**03	KDP-1414	0070 01001407	STS-R0	3914 00000006	Flat 17mm width	
STM12	FSC-09	STS12	3914 1100**03	HTP-09	1314 00000009	STS-R1	3914 10000006	S-1L	0803 00000011
STM18	FSC-16	STS18	3914 310**03	HTP-16	1314 00000016	STS-R2	3914 30000006	S-4L	0803 00000014
STM30	FSC-22	STS30	3914 410**03	HTP-22	1314 00000022	STS-R2	3914 30000006	S-5L	0803 00000015



- BT
- CAT
- AHO
- HSK-A/E/F/C
- HSK-T
- UTS
- Specialized Machine
- Related Equipment
- Bush & Chamfering Drill
- Milling Chuck
- Collet Holder
- "R"-Zero Holder
- Hydraulic Chuck
- Shrink Fit
- Tapping Chuck
- Arbors
- Function Holder
- Retention Stud
- Tool Shank Dimensions

STM

Synchronous Tap Holder With Easy Tool Length Adjustment

- Projection length of the cutting tool can be adjusted by simply turning circumference of the holder.

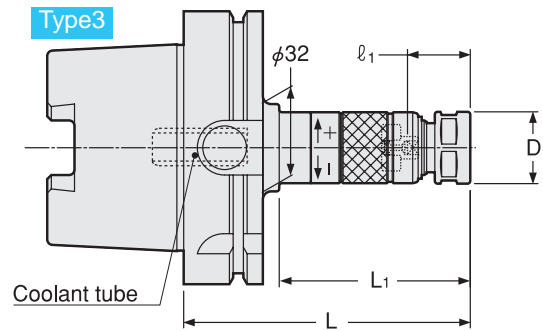
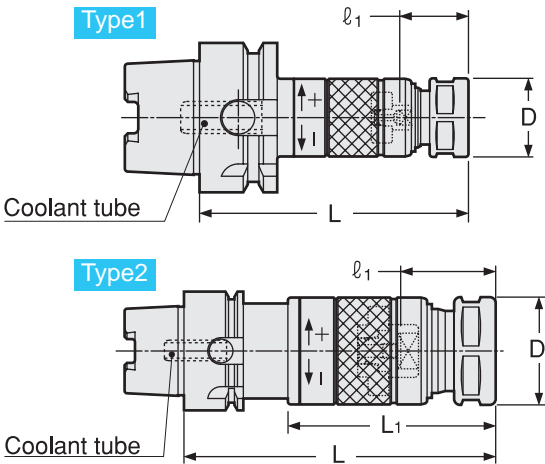

! For capable tap sizes, please refer to P.462-464 chart.

(NOTE) Nut O.D. of STM8 is 19mm.

STM Holder + Collet + STS Driver

- Coolant tube is included.

Unit : Metric

Code	Model	Type	Tap Size	L	L1	D	Nut	kg	Collet	Preset Driver	Spanner
5610 13000075	HSK40A -STM8 -75 *	1	Old JIS Taps M4~8 U No8~5/16 OSG Synchro Taps M4~6	75	—	21	KDP-1414		FDC-07	STS-8	Flat 17mm width
5610 13000090	-90	1		90	—	21	KDP-1414				
5610 13000005	-105	1		105	—	21	KDP-1414				
5610 13000020	-120	1		120	—	21	KDP-1414				
5610 13100075	HSK40A -STM12 -75 *	1	Old JIS Taps M4~12 U No8~7/16 PT1/8 OSG Synchro Taps M4~10	75	—	26	HTP-09		FSC-09	STS-12	S-1L
5610 13100090	-90	1		90	—	26	HTP-09				
5610 13100005	-105	1		105	—	26	HTP-09				
5610 13100020	-120	1		120	—	26	HTP-09				
5610 13300005	HSK40A -STM18 -105	2	Old JIS Taps M14~18 U1/2~3/4 PT1/4~3/8 OSG Synchro Taps M12~14	105	70	36	HTP-16	0.6	FSC-16	STS-18	S-4L
5610 13300020	-120	2		120	85	36	HTP-16				
5610 13300035	-135	2		135	100	36	HTP-16				
5610 13300050	-150	2		150	115	36	HTP-16				
5610 14000075	HSK50A -STM8 -75 *	1	Old JIS Taps M4~8 U No8~5/16 OSG Synchro Taps M4~6	75	—	21	KDP-1414		FDC-07	STS-8	Flat 17mm width
5610 14000090	-90	1		90	—	21	KDP-1414	0.6			
5610 14000005	-105	1		105	—	21	KDP-1414	0.6			
5610 14000020	-120	1		120	—	21	KDP-1414	0.6			
5610 14100090	HSK50A -STM12 -90	1	Old JIS Taps M4~12 U No8~7/16 PT1/8 OSG Synchro Taps M4~10	90	—	26	HTP-09	0.6	FSC-09	STS-12	S-1L
5610 14100005	-105	1		105	—	26	HTP-09	0.7			
5610 14100020	-120	1		120	—	26	HTP-09				
5610 14300005	HSK50A -STM18 -105	1		105	—	36	HTP-16	0.8			
5610 14300020	-120	1	Old JIS Taps M14~18 U1/2~3/4 PT1/4~3/8 OSG Synchro Taps M12~14	120	—	36	HTP-16	0.9	FSC-16	STS-18	S-4L
5610 14300035	-135	1		135	—	36	HTP-16	1.0			
5610 14300050	-150	1		150	—	36	HTP-16				
5610 15000075	HSK63A -STM8 -75 *	1		Old JIS Taps M4~8 U No8~5/16 OSG Synchro Taps M4~6	75	—	21	KDP-1414			
5610 15000090	-90	1	90		—	21	KDP-1414				
5610 15000005	-105	1	105		—	21	KDP-1414				
5610 15000020	-120	1	120		—	21	KDP-1414				
5610 15000035	-135	1	135		—	21	KDP-1414				
5610 15000050	-150	1	150		—	21	KDP-1414				
5610 15100090	HSK63A -STM12 -90	1	Old JIS Taps M4~12 U No8~7/16 PT1/8 OSG Synchro Taps M4~10	90	—	26	HTP-09	0.9	FSC-09	STS-12	S-1L
5610 15100005	-105	1		105	—	26	HTP-09	0.9			
5610 15100020	-120	1		120	—	26	HTP-09	1.0			
5610 15100035	-135	1		135	—	26	HTP-09	1.0			
5610 15100050	-150	1		150	—	26	HTP-09	1.1			
5610 15100080	-180	1		180	—	26	HTP-09	1.2			
5610 15300005	HSK63A -STM18 -105	1	Old JIS Taps M14~18 U1/2~3/4 PT1/4~3/8 OSG Synchro Taps M12~14	105	—	36	HTP-16	1.1	FSC-16	STS-18	S-4L
5610 15300020	-120	1		120	—	36	HTP-16	1.2			
5610 15300035	-135	1		135	—	36	HTP-16	1.3			
5610 15300050	-150	1		150	—	36	HTP-16	1.4			
5610 15300080	-180	1		180	—	36	HTP-16				
5610 15400020	HSK63A -STM30 -120	1		Old JIS Taps M20~30 U7/8~1-1/8 PT1/2~3/4 OSG Synchro Taps M16~27	120	—	46	HTP-22			
5610 15400035	-135	1	135		—	46	HTP-22				
5610 15400050	-150	1	150		—	46	HTP-22				
5610 15400080	-180	1	180		—	46	HTP-22				
5610 17000090	HSK100A -STM8 -90 *	3	Old JIS Taps M4~8 U No8~5/16 OSG Synchro Taps M4~6	90	53	21	KDP-1414		FDC-07	STS-8	Flat 17mm width
5610 17000005	-105	3		105	68	21	KDP-1414				
5610 17000020	-120	3		120	83	21	KDP-1414				
5610 17000035	-135	3		135	98	21	KDP-1414				
5610 17000050	-150	3		150	113	21	KDP-1414				
5610 17000065	-165	3		165	128	21	KDP-1414				

Code	Model	Type	Tap Size	L	L1	D	Nut	kg	Collet	Preset Driver	Spanner
5610 17100090	HSK100A -STM12 -90 *	3	Old JIS Taps M4~12 U No8~7/16 PT1/8 OSG Synchro Taps M4~10	90	53	26	HTP-09	2.3	FSC-09	STS-12	S-1L
5610 17100005	-105	3		105	68	26	HTP-09				
5610 17100020	-120	3		120	83	26	HTP-09				
5610 17100035	-135	3		135	98	26	HTP-09				
5610 17100050	-150	3		150	113	26	HTP-09				
5610 17100080	-180	3	180	143	26	HTP-09					
5610 17300005	HSK100A -STM18 -105	1	Old JIS Taps M14~18 U1/2~3/4 PT1/4~3/8 OSG Synchro Taps M12~14	105	-	36	HTP-16	2.4	FSC-16	STS-18	S-4L
5610 17300020	-120	1		120	-	36	HTP-16				
5610 17300035	-135	1		135	-	36	HTP-16				
5610 17300050	-150	1		150	-	36	HTP-16				
5610 17300080	-180	1		180	-	36	HTP-16				
5610 17400020	HSK100A -STM30 -120	1	Old JIS Taps M20~30 U7/8~1-1/8 PT1/2~3/4 OSG Synchro Taps M16~27	120	-	46	HTP-22	2.7	FSC-22	STS-30	S-5L
5610 17400035	-135	1		135	-	46	HTP-22				
5610 17400050	-150	1		150	-	46	HTP-22				
5610 17400080	-180	1		180	-	46	HTP-22				
5610 17400010	-210	1		210	-	46	HTP-22				

1. Collet, spanner and preset driver are sold separately.
2. Please see below for $\ell 1$ dimension.
3. Tap holes smaller than M4 can be made by STM8. Collets to be used are as follows.
M1-M2.6: FDC-03007- ※※ M3-M3.5: FDC-04007- ※※
Tap drive will not be used for the above usages.

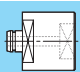
Collet	Preset driver	Ordering Example
P.336	P.334-335	HSK40A - STM 8 - 90
		Shank size Holder size Projection length (L)

$\ell 1$ Dimension for STM

Old JIS Taps			
Without center-through coolant			
Tap sizes	$\ell 1$	$\ell 1(*)$	
M4 ~ 6 U No.8 ~ 1/4	21 ~ 35	21 ~ 26	
M7 ~ 12 U 5/16 ~ U7/16 PT1/8	23 ~ 37	23 ~ 28	
M13 ~ 15 U 1/2 ~ 5/8 PT1/4	28 ~ 42	-	
M16 ~ 17 M18 ~ 27 U 3/4 ~ U1 PT3/8 ~ 5/8	32 ~ 45	-	
M30 U1-1/8 PT3/4	33 ~ 47	-	
	38 ~ 52	-	
With center-through coolant (STM8)			
Tap sizes	$\ell 1$	$\ell 1(*)$	
M4 ~ 6 U No.8 ~ 1/4	25 ~ 35	25 ~ 26	
M7 ~ 8 U5/16	26 ~ 37	26 ~ 28	
With center-through coolant (STM12 ~ 30)			
Tap sizes	$\ell 1$	$\ell 1(*)$	
M4 ~ 6 U No.8 ~ 1/4	24 ~ 35	24 ~ 26	
M7 ~ 10 U 5/16 ~ 3/8	25 ~ 37	25 ~ 28	
M11 ~ 12 U 7/16 PT 1/8	26 ~ 37	26 ~ 28	
U1/2	32 ~ 42	-	
M13 ~ 15 U9/16 U5/8 PT1/4	33 ~ 42	-	
M16	34 ~ 42	-	
M18 U 3/4 PT3/8	35 ~ 46	-	
M36 ~ 47	36 ~ 47	-	
M20 ~ 21 PT1/2	40 ~ 47	-	
M22 U 7/8	41 ~ 47	-	
M23	42 ~ 47	-	
M24 ~ 25 PT5/8	42 ~ 47	-	
M26 ~ 27 U1	43 ~ 47	-	
M28	44 ~ 47	-	
M28 M30 PT3/4	45 ~ 52	-	
U 1-1/8	46 ~ 52	-	
	48 ~ 52	-	

OSG Synchro Taps			
Without center-through coolant			
Tap sizes	$\ell 1$	$\ell 1(*)$	
M4 ~ 6	21 ~ 35	21 ~ 26	
M8 ~ 10	23 ~ 37	23 ~ 28	
M12 ~ 14	28 ~ 42	-	
M16 ~ 27	33 ~ 47	-	
With center-through coolant (STM8)			
Tap sizes	$\ell 1$	$\ell 1(*)$	
M4 ~ 6	25 ~ 35	25 ~ 26	
With center-through coolant (STM12 ~ 30)			
Tap sizes	$\ell 1$	$\ell 1(*)$	
M4 ~ 6	24 ~ 35	24 ~ 26	
M8 ~ 10	26 ~ 37	26 ~ 28	
M12	33 ~ 42	-	
M14	34 ~ 42	-	
M16 ~ 20	40 ~ 46	-	
M22 ~ 27	44 ~ 47	-	

YAMAWA X Series			
Without center-through coolant			
Tap sizes	$\ell 1$	$\ell 1(*)$	
M6 M8	23 ~ 37	23 ~ 28	
M10 M12	28 ~ 42	-	
With center-through coolant (STM8)			
Tap sizes	$\ell 1$	$\ell 1(*)$	
M6	26 ~ 37	26 ~ 28	
With center-through coolant (STM12 ~ 30)			
Tap sizes	$\ell 1$	$\ell 1(*)$	
M6	25 ~ 37	25 ~ 28	
M8	26 ~ 37	26 ~ 28	
M10	33 ~ 42	-	
M12	34 ~ 42	-	

Tap size reference chart (collet, preset driver)

FDC-07 or FSC - collet

preset driver & tool for changing driver

OH Type

● OH type collet should be used for center-through coolant feeding and external coolant feeding.

C Type

● when "collet-through" coolant feeding is needed.

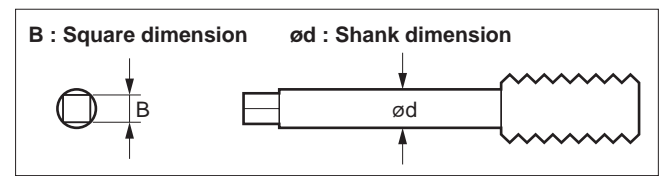
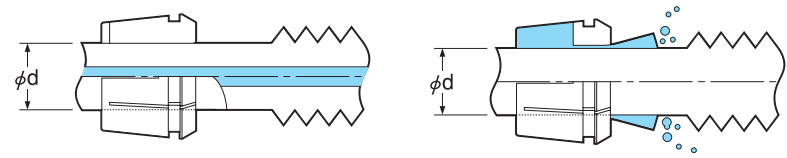

※ Please select OH type for non-coolant use.

STS Type

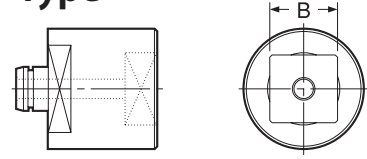

STS-R Type

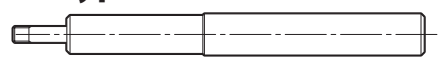

Holder Model	Tap Size (ANSI)	ød (inch)	ød (mm)	Collet Model (OH or C)	B (inch)	B (mm)	Preset Driver
STM8	#0-6	0.141	3.5814	FDC-03607**	0.110	2.794	STS8-□ 2.8
	#8	0.168	4.2672	FDC-04307**	0.131	3.3274	STS8-□ 3.4
	#10	0.194	4.9276	FDC-05007**	0.152	3.8608	STS8-□ 4.0
	#12	0.22	5.588	FDC-05607**	0.165	4.191	STS8-□ 4.2
	1/4	0.255	6.477	FDC-06507**	0.191	4.8514	STS8-□ 5.0
STM12	#0-6	0.141	3.5814	FSC-09-3.6**	0.110	2.794	STS12-□ 2.8
	#8	0.168	4.2672	FSC-09-4.3**	0.131	3.3274	STS12-□ 3.4
	#10	0.194	4.9276	FSC-09-5.0**	0.152	3.8608	STS12-□ 4.0
	#12	0.22	5.588	FSC-09-5.6**	0.165	4.191	STS12-□ 4.2
	1/4	0.255	6.477	FSC-09-6.5**	0.191	4.8514	STS12-□ 5.0
	1/8SPT	0.313	7.9502	FSC-09-8.0**	0.234	5.9436	STS12-□ 6.0
	5/16	0.318	8.0772	FSC-09-8.1**	0.238	6.0452	STS12-□ 6.1
	7/16	0.323	8.2042	FSC-09-8.3**	0.242	6.1468	STS12-□ 6.2
STM18	1/2	0.367	9.3218	FSC-16-9.4**	0.275	6.985	STS18-□ 7.0
	3/8	0.381	9.6774	FSC-16-9.7**	0.286	7.2644	STS18-□ 7.3
	9/16	0.429	10.8966	FSC-16-10.9**	0.322	8.1788	STS18-□ 8.2
	1/8LPT	0.437	11.0998	FSC-16-11.1**	0.328	8.3312	STS18-□ 8.4
	5/8	0.48	12.192	FSC-16-12.2**	0.360	9.144	STS18-□ 9.2
	11/16	0.542	13.7668	FSC-16-13.8**	0.406	10.3124	STS18-□ 10.4
	1/4PT	0.562	14.2748	FSC-16-14.3**	0.421	10.6934	STS18-□ 10.7
STM30	3/4	0.59	14.986	FSC-22-15.0**	0.442	11.2268	STS30-□ 11.3
	13/16	0.652	16.5608	FSC-22-16.6**	0.489	12.4206	STS30-□ 12.5
	7/8	0.697	17.7038	FSC-22-17.8**	0.523	13.2842	STS30-□ 13.3
	3/8PT	0.7	17.78	FSC-22-17.8**	0.531	13.4874	STS30-□ 13.5
	1	0.8	20.32	FSC-22-20.4**	0.600	15.24	STS30-□ 15.3

For DIN and ISO, please refer to P.463-464.

Ordering Example

FSC - 22 - 20.4 - OH

Collet size Collet I.D. (d) OH: for tool with coolant hole
C: for collet through

Combination of accessories

Tap holder	Collet	Preset driver		Nut		Tool changing driver		Spanner	
Model	Model	Model	Code	Model	Code	Model	Code	Model	Code
STM8	FDC-07	STS8	3914 0100**03	KDP-1414	0070 01001407	STS-R0	3914 00000006	Flat 17mm width	
STM12	FSC-09	STS12	3914 1100**03	HTP-09	1314 00000009	STS-R1	3914 10000006	S-1L	0803 00000011
STM18	FSC-16	STS18	3914 310**03	HTP-16	1314 00000016	STS-R2	3914 30000006	S-4L	0803 00000014
STM30	FSC-22	STS30	3914 410**03	HTP-22	1314 00000022	STS-R2	3914 30000006	S-5L	0803 00000015



Tap size reference chart (collet, preset driver)

FDC-07 or FSC - collet

preset driver & tool for changing driver

OH Type

● OH type collet should be used for center-through coolant feeding and external coolant feeding.

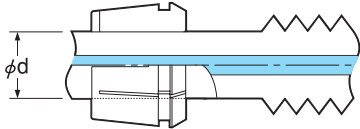

C Type

● when "collet-through" coolant feeding is needed.

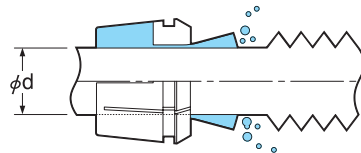

STS Type

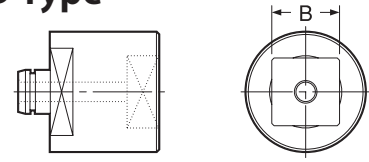

STS-R Type

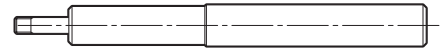

※ Please select OH type for non-coolant use.

Holder Model	Tap Size					ød	Collet Model (OH or C)	B	Preset Driver	Tool for Changing Driver	
	Metric Thread	Unified Thread	Pipe Taper Thread	OSG Synchro-Taps	YAMAWA X Series						
STM8	M4-M4.5	UNo.8				5.0	FDC-05007-**	4.0	STS8-□4.0	STS-R0	
	M5-M5.5	UNo.10~12				5.5	FDC-05507-**	4.5	STS8-□4.5	STS-R0	
	M6	U1/4		M4-M6		6.0	FDC-06007-**	4.5	STS8-□4.5	STS-R0	
					M6	6.0	FDC-06007-**	4.9	STS8-□4.9	STS-R0	
			U5/16			6.1	FDC-06107-**	5.0	STS8-□5.0	STS-R0	
	M7-8				6.2	FDC-06207-**	5.0	STS8-□5.0	STS-R0		
STM12	M4-M4.5	UNo.8				5.0	FSC-09-5.0-**	4.0	STS12-□4.0	STS-R1	
	M5-M5.5	UNo.10~12				5.5	FSC-09-5.5-**	4.5	STS12-□4.5	STS-R1	
	M6	U1/4		M4-M6		6.0	FSC-09-6.0-**	4.5	STS12-□4.5	STS-R1	
					M6	6.0	FSC-09-6.0-**	4.9	STS12-□4.9	STS-R1	
			U5/16			6.1	FSC-09-6.1-**	5.0	STS12-□5.0	STS-R1	
		M7-8				6.2	FSC-09-6.2-**	5.0	STS12-□5.0	STS-R1	
		M9-M10	U3/8			7.0	FSC-09-7.0-**	5.5	STS12-□5.5	STS-R1	
					M8	8.0	FSC-09-8.0-**	6.2	STS12-□6.2	STS-R1	
	M11	U7/16	PT1/16~1/8	M8-M10		8.0	FSC-09-8.0-**	6.0	STS12-□6.0	STS-R1	
	M12					8.5	FSC-09-8.5-**	6.5	STS12-□6.5	STS-R1	
STM18		U1/2				9.0	FSC-16-9.0-**	7.0	STS18-□7.0	STS-R2	
	M13					9.5	FSC-16-9.5-**	7.0	STS18-□7.0	STS-R2	
				M12	M10	10.0	FSC-16-10.0-**	8.0	STS18-□8.0	STS-R2	
	M14-15	U9/16				10.5	FSC-16-10.5-**	8.0	STS18-□8.0	STS-R2	
			PT1/4			11.0	FSC-16-11.0-**	9.0	STS18-□9.0	STS-R2	
			U5/8		M14	M12	12.0	FSC-16-12.0-**	9.0	STS18-□9.0	STS-R2
		M16					12.5	FSC-16-12.5-**	10.0	STS18-□10.0	STS-R2
	M17					13.0	FSC-16-13.0-**	10.0	STS18-□10.0	STS-R2	
STM30	M18-M19	U3/4	PT3/8			14.0	FSC-16-14.0-**	11.0	STS18-□11.0	STS-R2	
	M20					15.0	FSC-22-15.0-**	12.0	STS30-□12.0	STS-R2	
	M21			M16-M20		16.0	FSC-22-16.0-**	12.0	STS30-□12.0	STS-R2	
	M22	U7/8				17.0	FSC-22-17.0-**	13.0	STS30-□13.0	STS-R2	
	M23		PT1/2			18.0	FSC-22-18.0-**	14.0	STS30-□14.0	STS-R2	
	M24-M25		PT5/8			19.0	FSC-22-19.0-**	15.0	STS30-□15.0	STS-R2	
	M26-M27	U1		M22-M27		20.0	FSC-22-20.0-**	15.0	STS30-□15.0	STS-R2	
	M28					21.0	FSC-22-21.0-**	17.0	STS30-□17.0	STS-R2	
		U1-1/8			22.0	FSC-22-22.0-**	17.0	STS30-□17.0	STS-R2		
	M30		PT3/4			23.0	FSC-22-23.0-**	17.0	STS30-□17.0	STS-R2	

Ordering Example

FSC - 22 - 20.0 - OH

Collet size

Collet I.D. (d)

OH: for tool with coolant hole

C: for collet through

Combination of accessories

Tap holder	Collet	Preset driver		Nut		Tool changing driver		Spanner	
Model	Model	Model	Code	Model	Code	Model	Code	Model	Code
STM8	FDC-07	STS8	3914 0100**03	KDP-1414	0070 01001407	STS-R0	3914 00000006	Flat 17mm width	
STM12	FSC-09	STS12	3914 1100**03	HTP-09	1314 00000009	STS-R1	3914 10000006	S-1L	0803 00000011
STM18	FSC-16	STS18	3914 310**03	HTP-16	1314 00000016	STS-R2	3914 30000006	S-4L	0803 00000014
STM30	FSC-22	STS30	3914 410**03	HTP-22	1314 00000022	STS-R2	3914 30000006	S-5L	0803 00000015

STM

Synchronous Tap Holder With Easy Tool Length Adjustment

● Projection length of the cutting tool can be adjusted by simply turning circumference of the holder.

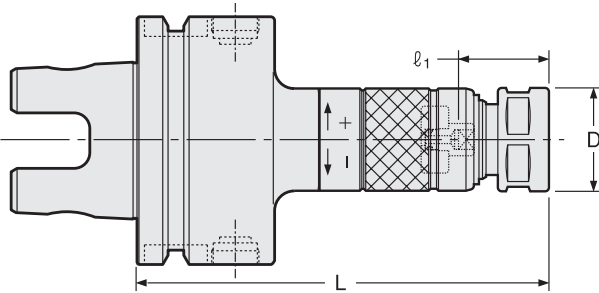

⚠ For capable tap sizes, please refer to P.462-464 chart.

(NOTE) Nut O.D. of STM8 is 19mm.

STM Holder + **Collet** + **STS Driver**

Unit : Metric

Code	Model	Tap Size	L	D	Nut	kg	Collet	Preset Driver	Spanner
1370 00400090	UTS5040 -STM8 -90H	Old JIS Taps	90	21	KDP-1414				
1370 00400105	-105H	M4 ~ 8 U No8 ~ 5/16	105	21	KDP-1414		FDC-07	STS-8	Flat 17mm width
1370 00400120	-120H	OSG Synchro Taps M4 ~ 6	120	21	KDP-1414				
1370 10400090	UTS5040 -STM12 -90H	Old JIS Taps	90	26	HTP-09				
1370 10400105	-105H	M4 ~ 12 U No8 ~ 7/16 PT1/8	105	26	HTP-09		FSC-09	STS-12	S-1L
1370 10400120	-120H	OSG Synchro Taps M4 ~ 10	120	26	HTP-09				
1370 30400105	UTS5040 -STM18 -105H	Old JIS Taps	105	36	HTP-16				
1370 30400120	-120H	M14 ~ 18 U1/2 ~ 3/4 PT1/4 ~ 3/8	120	36	HTP-16		FSC-16	STS-18	S-4L
1370 30400135	-135H	OSG Synchro Taps M12 ~ 14	135	36	HTP-16				
1370 30400150	-150H	M12 ~ 14	150	36	HTP-16				
1370 40400120	UTS5040 -STM30 -120H	Old JIS Taps	120	46	HTP-22				
1370 40400135	-135H	M20 ~ 30 U7/8 ~ 1-1/8 PT1/2 ~ 3/4	135	46	HTP-22		FSC-22	STS-30	S-5L
1370 40400150	-150H	OSG Synchro Taps M16 ~ 27	150	46	HTP-22				
1370 00 ※ 00090	UTS6350 -STM8 -90 ※	Old JIS Taps	90	21	KDP-1414				
1370 00 ※ 00105	-105	M4 ~ 8 U No8 ~ 5/16	105	21	KDP-1414		FDC-07	STS-8	Flat 17mm width
1370 00 ※ 00120	-120	OSG Synchro Taps M4 ~ 6	120	21	KDP-1414				
1370 00 ※ 00135	-135		135	21	KDP-1414				
1370 00 ※ 00150	-150		150	21	KDP-1414				
1370 10 ※ 00090	UTS6350 -STM12 -90 ※	Old JIS Taps	90	26	HTP-09	1.1			
1370 10 ※ 00105	-105	M4 ~ 12 U No8 ~ 7/16 PT1/8	105	26	HTP-09		FSC-09	STS-12	S-1L
1370 10 ※ 00120	-120	OSG Synchro Taps M4 ~ 10	120	26	HTP-09				
1370 10 ※ 00135	-135		135	26	HTP-09				
1370 10 ※ 00150	-150		150	26	HTP-09				
1370 10 ※ 00180	-180		180	26	HTP-09				
1370 30 ※ 00105	UTS6350 -STM18 -105	Old JIS Taps	105	36	HTP-16	1.2			
1370 30 ※ 00120	-120	M14 ~ 18 U1/2 ~ 3/4 PT1/4 ~ 3/8	120	36	HTP-16		FSC-16	STS-18	S-4L
1370 30 ※ 00135	-135	OSG Synchro Taps M12 ~ 14	135	36	HTP-16				
1370 30 ※ 00150	-150		150	36	HTP-16				
1370 30 ※ 00180	-180		180	36	HTP-16				
1370 40 ※ 00120	UTS6350 -STM30 -120	Old JIS Taps	120	46	HTP-22				
1370 40 ※ 00135	-135	M20 ~ 30 U7/8 ~ 1-1/8 PT1/2 ~ 3/4	135	46	HTP-22		FSC-22	STS-30	S-5L
1370 40 ※ 00150	-150	OSG Synchro Taps M16 ~ 27	150	46	HTP-22				
1370 40 ※ 00180	-180		180	46	HTP-22				
1370 00 ※ 00090	UTS10080 -STM8 -90 ※	Old JIS Taps	90	21	KDP-1414				
1370 00 ※ 00105	-105	M4 ~ 8 U No8 ~ 5/16	105	21	KDP-1414		FDC-07	STS-8	Flat 17mm width
1370 00 ※ 00120	-120	OSG Synchro Taps M4 ~ 6	120	21	KDP-1414				
1370 00 ※ 00135	-135		135	21	KDP-1414				
1370 00 ※ 00150	-150		150	21	KDP-1414				
1370 00 ※ 00165	-165		165	21	KDP-1414				
1370 10 ※ 00090	UTS10080 -STM12 -90 ※	Old JIS Taps	90	26	HTP-09	2.8			
1370 10 ※ 00105	-105	M4 ~ 12 U No8 ~ 7/16 PT1/8	105	26	HTP-09		FSC-09	STS-12	S-1L
1370 10 ※ 00120	-120	OSG Synchro Taps M4 ~ 10	120	26	HTP-09				
1370 10 ※ 00135	-135		135	26	HTP-09				
1370 10 ※ 00150	-150		150	26	HTP-09				
1370 10 ※ 00180	-180		180	26	HTP-09				
1370 30 ※ 00105	UTS10080 -STM18 -105	Old JIS Taps	105	36	HTP-16	2.7			
1370 30 ※ 00120	-120	M14 ~ 18 U1/2 ~ 3/4 PT1/4 ~ 3/8	120	36	HTP-16		FSC-16	STS-18	S-4L
1370 30 ※ 00135	-135	OSG Synchro Taps M12 ~ 14	135	36	HTP-16				
1370 30 ※ 00150	-150		150	36	HTP-16	3.0			
1370 30 ※ 00180	-180		180	36	HTP-16				
1370 40 ※ 00120	UTS10080 -STM30 -120	Old JIS Taps	120	46	HTP-22				
1370 40 ※ 00135	-135	M20 ~ 30 U7/8 ~ 1-1/8 PT1/2 ~ 3/4	135	46	HTP-22		FSC-22	STS-30	S-5L
1370 40 ※ 00150	-150	OSG Synchro Taps M16 ~ 27	150	46	HTP-22				
1370 40 ※ 00180	-180		180	46	HTP-22				
1370 40 ※ 00210	-210		210	46	HTP-22				

When placing an order, please specify high or low pressure. For high pressure type, please add (-H) on end of the description.

1. Collet, spanner and preset driver are sold separately.
2. Please see below for $\ell 1$ dimension.
3. Tap holes smaller than M4 can be made by STM8. Collets to be used are as follows.
M1-M2.6: FDC-03007- ※※ M3-M3.5: FDC-04007- ※※
Tap drive will not be used for the above usages.
4. UTS5040 is available in high pressure only.

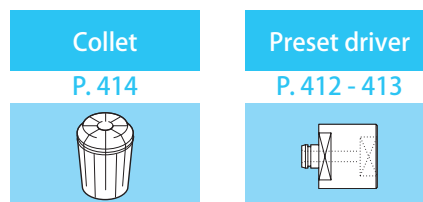

Ordering Example

Low pressure type

0 ~ 1.0MPa (UTS10080 : 0 ~ 2.0MPa)

UTS6350 - STM 12 - 90
Shank size Holder soze Projection length (L)

Ordering Example

High pressure type

1.1 ~ 7.0MPa (UTS10080 : 2.1 ~ 7.0MPa)

UTS6350 - STM 12 - 90 - H
Shank size Holder soze Projection length (L) High pressure type

$\ell 1$ Dimension for STM

Old JIS Taps

Without center-through coolant		
Tap Size	$\ell 1$	$\ell 1(*)$
M4 ~ 6 U No.8 ~ 1/4	21 ~ 35	21 ~ 26
M7 ~ 12 U 5/16 ~ U7/16 PT1/8	23 ~ 37	23 ~ 28
M13 ~ 15 U 1/2 ~ 5/8 PT1/4	28 ~ 42	-
M16 ~ 17	32 ~ 45	-
M18 ~ 27 U 3/4 ~ U1 PT3/8 ~ 5/8	33 ~ 47	-
M30 U1-1/8 PT3/4	38 ~ 52	-
With center-through coolant (STM8)		
Tap Size	$\ell 1$	$\ell 1(*)$
M4 ~ 6 U No.8 ~ 1/4	25 ~ 35	25 ~ 26
M7 ~ 8 U5/16	26 ~ 37	26 ~ 28
With center-through coolant (STM12 ~ 30)		
Tap Size	$\ell 1$	$\ell 1(*)$
M4 ~ 6 U No.8 ~ 1/4	24 ~ 35	24 ~ 26
M7 ~ 10 U 5/16 ~ 3/8	25 ~ 37	25 ~ 28
M11 ~ 12 U 7/16 PT 1/8	26 ~ 37	26 ~ 28
U1/2	32 ~ 42	-
M13 ~ 15 U9/16	33 ~ 42	-
U5/8 PT1/4	34 ~ 42	-
M16	35 ~ 46	-
M18 U 3/4 PT3/8	36 ~ 47	-
M20 ~ 21 PT1/2	40 ~ 47	-
M22 U 7/8	41 ~ 47	-
M23	42 ~ 47	-
M24 ~ 25 PT5/8	43 ~ 47	-
M26 ~ 27 U1	44 ~ 47	-
M28	45 ~ 52	-
M30 PT3/4	46 ~ 52	-
U 1-1/8	48 ~ 52	-

OSG Synchro Taps

Without center-through coolant		
Tap Size	$\ell 1$	$\ell 1(*)$
M4 ~ 6	21 ~ 35	21 ~ 26
M8 ~ 10	23 ~ 37	23 ~ 28
M12 ~ 14	28 ~ 42	-
M16 ~ 27	33 ~ 47	-
With center-through coolant (STM8)		
Tap Size	$\ell 1$	$\ell 1(*)$
M4 ~ 6	25 ~ 35	25 ~ 26
With center-through coolant (STM12 ~ 30)		
Tap Size	$\ell 1$	$\ell 1(*)$
M4 ~ 6	24 ~ 35	24 ~ 26
M8 ~ 10	26 ~ 37	26 ~ 28
M12	33 ~ 42	-
M14	34 ~ 42	-
M16 ~ 20	40 ~ 46	-
M22 ~ 27	44 ~ 47	-

YAMAWA X Series

Without center-through coolant		
Tap Size	$\ell 1$	$\ell 1(*)$
M6 M8	23 ~ 37	23 ~ 28
M10 M12	28 ~ 42	-
With center-through coolant (STM8)		
Tap Size	$\ell 1$	$\ell 1(*)$
M6	26 ~ 37	26 ~ 28
With center-through coolant (STM12 ~ 30)		
Tap Size	$\ell 1$	$\ell 1(*)$
M6	25 ~ 37	25 ~ 28
M8	26 ~ 37	26 ~ 28
M10	33 ~ 42	-
M12	34 ~ 42	-

Tap size reference chart (collet, preset driver)

FDC-07 or FSC - collet

preset driver & tool for changing driver

OH Type

● OH type collet should be used for center-through coolant feeding and external coolant feeding.

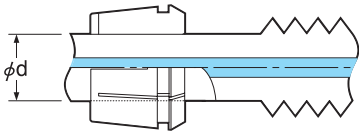

C Type

● when "collet-through" coolant feeding is needed.

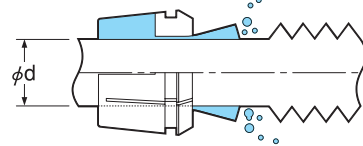

STS Type

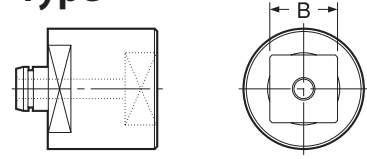

STS-R Type

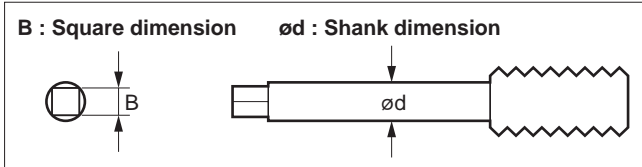
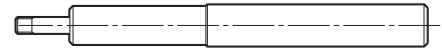

※ Please select OH type for non-coolant use.

Holder Model	Tap Size (ANSI)	ød (inch)	ød (mm)	Collet Model (OH or C)	B (inch)	B (mm)	Preset Driver
STM8	#0-6	0.141	3.5814	FDC-03607**	0.110	2.794	STS8-□ 2.8
	#8	0.168	4.2672	FDC-04307**	0.131	3.3274	STS8-□ 3.4
	#10	0.194	4.9276	FDC-05007**	0.152	3.8608	STS8-□ 4.0
	#12	0.22	5.588	FDC-05607**	0.165	4.191	STS8-□ 4.2
	1/4	0.255	6.477	FDC-06507**	0.191	4.8514	STS8-□ 5.0
STM12	#0-6	0.141	3.5814	FSC-09-3.6**	0.110	2.794	STS12-□ 2.8
	#8	0.168	4.2672	FSC-09-4.3**	0.131	3.3274	STS12-□ 3.4
	#10	0.194	4.9276	FSC-09-5.0**	0.152	3.8608	STS12-□ 4.0
	#12	0.22	5.588	FSC-09-5.6**	0.165	4.191	STS12-□ 4.2
	1/4	0.255	6.477	FSC-09-6.5**	0.191	4.8514	STS12-□ 5.0
	1/8SPT	0.313	7.9502	FSC-09-8.0**	0.234	5.9436	STS12-□ 6.0
	5/16	0.318	8.0772	FSC-09-8.1**	0.238	6.0452	STS12-□ 6.1
	7/16	0.323	8.2042	FSC-09-8.3**	0.242	6.1468	STS12-□ 6.2
STM18	1/2	0.367	9.3218	FSC-16-9.4**	0.275	6.985	STS18-□ 7.0
	3/8	0.381	9.6774	FSC-16-9.7**	0.286	7.2644	STS18-□ 7.3
	9/16	0.429	10.8966	FSC-16-10.9**	0.322	8.1788	STS18-□ 8.2
	1/8LPT	0.437	11.0998	FSC-16-11.1**	0.328	8.3312	STS18-□ 8.4
	5/8	0.48	12.192	FSC-16-12.2**	0.360	9.144	STS18-□ 9.2
	11/16	0.542	13.7668	FSC-16-13.8**	0.406	10.3124	STS18-□ 10.4
	1/4PT	0.562	14.2748	FSC-16-14.3**	0.421	10.6934	STS18-□ 10.7
	3/4	0.59	14.986	FSC-22-15.0**	0.442	11.2268	STS30-□ 11.3
STM30	13/16	0.652	16.5608	FSC-22-16.6**	0.489	12.4206	STS30-□ 12.5
	7/8	0.697	17.7038	FSC-22-17.8**	0.523	13.2842	STS30-□ 13.3
	3/8PT	0.7	17.78	FSC-22-17.8**	0.531	13.4874	STS30-□ 13.5
	1	0.8	20.32	FSC-22-20.4**	0.600	15.24	STS30-□ 15.3

For DIN and ISO, please refer to P.463-464.

Ordering Example

FSC - 22 - 20.4 - OH

Collet size

Collet I.D. (d)

OH: for tool with coolant hole
C: for collet through

Combination of accessories

Tap holder	Collet	Preset driver		Nut		Tool changing driver		Spanner	
Model	Model	Model	Code	Model	Code	Model	Code	Model	Code
STM8	FDC-07	STS8	3914 0100**03	KDP-1414	0070 01001407	STS-R0	3914 00000006	Flat 17mm width	
STM12	FSC-09	STS12	3914 1100**03	HTP-09	1314 00000009	STS-R1	3914 10000006	S-1L	0803 00000011
STM18	FSC-16	STS18	3914 310**03	HTP-16	1314 00000016	STS-R2	3914 30000006	S-4L	0803 00000014
STM30	FSC-22	STS30	3914 410**03	HTP-22	1314 00000022	STS-R2	3914 30000006	S-5L	0803 00000015

Tap size reference chart (collet, preset driver)

FDC-07 or FSC - collet

preset driver & tool for changing driver

OH Type

● OH type collet should be used for center-through coolant feeding and external coolant feeding.

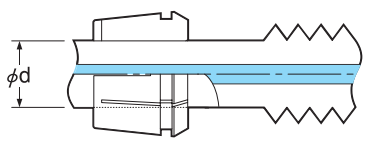

C Type

● when "collet-through" coolant feeding is needed.

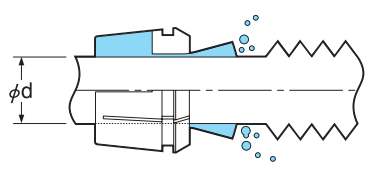

STS Type

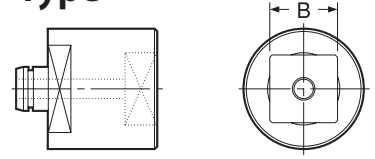

STS-R Type

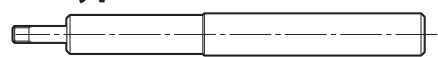

※ Please select OH type for non-coolant use.

Holder Model	Tap Size					ød	Collet Model (OH or C)	B	Preset Driver	Tool for Changing Driver
	Old JIS Taps			OSG Synchro-Taps	YAMAWA X Series					
	Metric Thread	Unified Thread	Pipe Taper Thread							
STM8	M4~M4.5	UNo.8				5.0	FDC-05007-**	4.0	STS8-□4.0	STS-R0
	M5~M5.5	UNo.10~12				5.5	FDC-05507-**	4.5	STS8-□4.5	STS-R0
	M6	U1/4		M4~M6		6.0	FDC-06007-**	4.5	STS8-□4.5	STS-R0
			U5/16		M6	6.0	FDC-06007-**	4.9	STS8-□4.9	STS-R0
	M7~8					6.1	FDC-06107-**	5.0	STS8-□5.0	STS-R0
					6.2	FDC-06207-**	5.0	STS8-□5.0	STS-R0	
STM12	M4~M4.5	UNo.8				5.0	FSC-09-5.0-**	4.0	STS12-□4.0	STS-R1
	M5~M5.5	UNo.10~12				5.5	FSC-09-5.5-**	4.5	STS12-□4.5	STS-R1
	M6	U1/4		M4~M6		6.0	FSC-09-6.0-**	4.5	STS12-□4.5	STS-R1
			U5/16		M6	6.0	FSC-09-6.0-**	4.9	STS12-□4.9	STS-R1
	M7~8					6.1	FSC-09-6.1-**	5.0	STS12-□5.0	STS-R1
	M9~M10	U3/8				7.0	FSC-09-7.0-**	5.5	STS12-□5.5	STS-R1
					M8	8.0	FSC-09-8.0-**	6.2	STS12-□6.2	STS-R1
	M11	U7/16	PT1/16~1/8	M8~M10		8.0	FSC-09-8.0-**	6.0	STS12-□6.0	STS-R1
	M12					8.5	FSC-09-8.5-**	6.5	STS12-□6.5	STS-R1
			U1/2			9.0	FSC-16-9.0-**	7.0	STS18-□7.0	STS-R2
				M12	M10	9.5	FSC-16-9.5-**	7.0	STS18-□7.0	STS-R2
STM18						10.0	FSC-16-10.0-**	8.0	STS18-□8.0	STS-R2
	M14~15	U9/16				10.5	FSC-16-10.5-**	8.0	STS18-□8.0	STS-R2
			PT1/4			11.0	FSC-16-11.0-**	9.0	STS18-□9.0	STS-R2
		U5/8		M14	M12	12.0	FSC-16-12.0-**	9.0	STS18-□9.0	STS-R2
	M16					12.5	FSC-16-12.5-**	10.0	STS18-□10.0	STS-R2
	M17					13.0	FSC-16-13.0-**	10.0	STS18-□10.0	STS-R2
	M18~M19	U3/4	PT3/8			14.0	FSC-16-14.0-**	11.0	STS18-□11.0	STS-R2
STM30	M20					15.0	FSC-22-15.0-**	12.0	STS30-□12.0	STS-R2
	M21			M16~M20		16.0	FSC-22-16.0-**	12.0	STS30-□12.0	STS-R2
	M22	U7/8				17.0	FSC-22-17.0-**	13.0	STS30-□13.0	STS-R2
	M23		PT1/2			18.0	FSC-22-18.0-**	14.0	STS30-□14.0	STS-R2
	M24~M25		PT5/8			19.0	FSC-22-19.0-**	15.0	STS30-□15.0	STS-R2
	M26~M27	U1		M22~M27		20.0	FSC-22-20.0-**	15.0	STS30-□15.0	STS-R2
	M28					21.0	FSC-22-21.0-**	17.0	STS30-□17.0	STS-R2
		U1-1/8				22.0	FSC-22-22.0-**	17.0	STS30-□17.0	STS-R2
	M30		PT3/4			23.0	FSC-22-23.0-**	17.0	STS30-□17.0	STS-R2

Ordering Example

FSC - 22 - 20.0 - OH

Collet size
Collet I.D. (d)

OH: for tool with coolant hole
C: for collet through

Combination of accessories

Tap holder	Collet	Preset driver		Nut		Tool changing driver		Spanner	
Model	Model	Model	Code	Model	Code	Model	Code	Model	Code
STM8	FDC-07	STS8	3914 0100**03	KDP-1414	0070 01001407	STS-R0	3914 00000006	Flat 17mm width	
STM12	FSC-09	STS12	3914 1100**03	HTP-09	1314 00000009	STS-R1	3914 10000006	S-1L	0803 00000011
STM18	FSC-16	STS18	3914 310**03	HTP-16	1314 00000016	STS-R2	3914 30000006	S-4L	0803 00000014
STM30	FSC-22	STS30	3914 410**03	HTP-22	1314 00000022	STS-R2	3914 30000006	S-5L	0803 00000015

