

CT·S

Super tite-lock Milling Chuck

- Slim design milling chuck. Specially designed slits enable heavy endmilling.

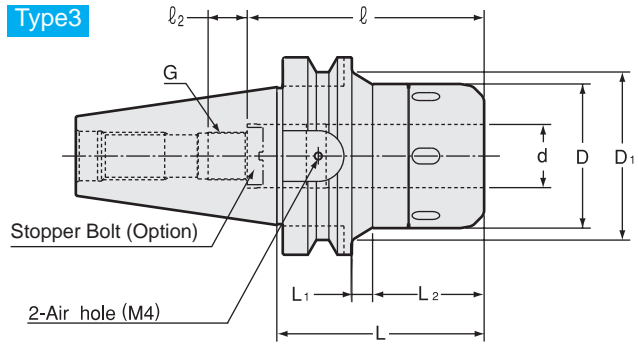
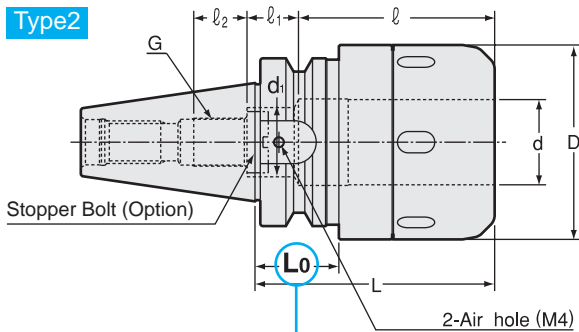
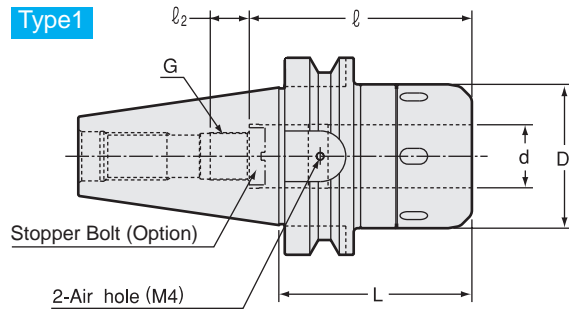
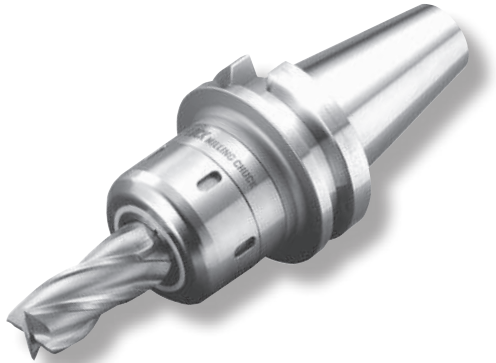

Caution

- ★ Take caution against A.T.C. arm and tool magazine interference.

Caution

- Please rotate the clamping ring counterclockwise more than 360 degrees after a cutting tool is removed.

Inch Sizes

Unit : Inch

Code	Model	Type	d	D	D1	L	L1	L2	ℓ	ℓ_1	ℓ_2	d1	L0	$G_{P=1.0}$	kg	Spanner
3140 10124075	BT30 -CT0750S -75	2	0.750	2.047	—	2.953	—	—	2.559	—	0.591	—	1.063	M12	1.0	HS-2-20
3140 10124090	-90	2	0.750	2.047	—	3.543	—	—	3.150	—	0.591	—	1.654	M12	1.4	
3140 10124105	-105	2	0.750	2.047	—	4.134	—	—	3.150	—	0.591	—	2.244	M12	1.4	
3140 10132090	BT30 -CT1000S -90	2	1.000	2.402	—	3.543	—	—	3.150	—	0.591	—	1.142	M12	1.4	HS-2.5-25
3140 10132105	-105	2	1.000	2.402	—	4.134	—	—	3.150	—	0.591	—	1.732	M12	1.6	
3140 10324075	BT40 -CT0750S -75	1	0.750	2.047	—	2.953	—	—	2.953	—	0.591	—	—	M12	1.6	HS-2-20
3140 10324090	-90	3	0.750	2.047	2.283	3.543	0.709	1.772	3.150	—	0.591	—	—	M12	1.8	
3140 10324105	-105	3	0.750	2.047	2.283	4.134	1.299	1.772	3.150	—	0.591	—	—	M12	2.0	
3140 10324120	-120	3	0.750	2.047	2.283	4.724	1.890	1.772	3.150	—	0.591	—	—	M12	2.2	
3140 10332090	BT40 -CT1000S -90	1	1.000	2.402	—	3.543	—	—	3.150	—	0.591	—	—	M12	2.0	HS-2.5-25
3140 10332105	-105	1	1.000	2.402	—	4.134	—	—	3.150	—	0.591	—	—	M12	2.3	
3140 10332120	-120	1	1.000	2.402	—	4.724	—	—	3.150	—	0.591	—	—	M12	—	
3140 10332135	-135	1	1.000	2.402	—	5.315	—	—	3.150	—	0.591	—	—	M12	—	
3140 10340090	BT40 -CT1250S -90	2	1.250	2.874	—	3.543	—	—	2.992	1.260	0.669	1.024	1.220	M18	2.3	HS-3-32
3140 10340105	-105	2	1.250	2.874	—	4.134	—	—	3.346	0.906	0.669	1.024	1.811	M18	2.6	
3140 10340120	-120	2	1.250	2.874	—	4.724	—	—	3.346	0.906	0.669	1.024	2.402	M18	2.9	
3140 10340135	-135	2	1.250	2.874	—	5.315	—	—	4.724	—	0.669	1.024	2.992	M18	3.1	
3140 10524090	BT50 -CT0750S -90	3	0.750	2.047	2.559	3.543	0.276	1.772	3.150	—	0.591	—	—	M12	—	HS-2-20
3140 10524105	-105	3	0.750	2.047	2.677	4.134	0.866	1.772	3.150	—	0.591	—	—	M12	4.5	
3140 10524135	-135	3	0.750	2.047	3.150	5.315	2.047	1.772	3.150	—	0.591	—	—	M12	—	
3140 10532105	BT50 -CT1000S -105	3	1.000	2.402	3.228	4.134	0.433	2.205	3.150	—	0.591	—	—	M12	4.7	HS-2.5-25
3140 10532135	-135	3	1.000	2.402	3.268	5.315	1.614	2.205	3.150	—	0.591	—	—	M12	—	
3140 10532165	-165	3	1.000	2.402	3.386	6.496	2.795	2.205	3.150	—	0.591	—	—	M12	—	

Inch Sizes Unit : Inch

Code	Model	Type	d	D	D1	L	L1	L2	ℓ	ℓ 1	ℓ 2	d1	L0	G P=1.0	kg	Spanner
3140 10540095	BT50 -CT1250S -95	1	1.250	2.874	—	3.740	—	—	4.724	—	0.787	—	—	M18		HS-3-32
3140 10540105	-105	3	1.250	2.874	3.386	4.134	0.433	2.205	4.724	—	0.787	—	—	M18	5.0	
3140 10540120	-120	3	1.250	2.874	3.425	4.724	1.024	2.205	4.724	—	0.787	—	—	M18		
3140 10540135	-135	3	1.250	2.874	3.386	5.315	1.614	2.205	4.724	—	0.787	—	—	M18	6.1	
3140 10540150	-150	3	1.250	2.874	3.465	5.906	2.205	2.205	4.724	—	0.787	—	—	M18		
3140 10540165	-165	3	1.250	2.874	3.465	6.496	2.795	2.205	4.724	—	0.787	—	—	M18	7.1	
3140 10564105	BT50 -CT2000S -105	2	2.000	4.134	—	4.134	—	—	3.937	—	0.787	—	1.654	M18		HS-4V
3140 10564120	-120	2	2.000	4.134	—	4.724	—	—	3.937	—	0.787	—	2.244	M18	7.1	
3140 10564135	-135	2	2.000	4.134	—	5.315	—	—	3.937	—	0.787	—	2.835	M18		
3140 10564150	-150	2	2.000	4.134	—	5.906	—	—	3.937	—	0.787	—	3.425	M18		
3140 10564165	-165	2	2.000	4.134	—	6.496	—	—	3.937	—	0.787	—	4.016	M18		

1. Use 2 pcs. of M4 x 5 (S) hex. screw (included) to close air holes on the holder when internal coolant is used.
2. When ordering, indicate number of spanners required. "No charge" spanners are limited to number of milling chucks on order.
3. Tolerance of cutting tool shank must be h7.

Ordering Example
BT30 - CT 0750 S - 75
 Shank size I.D. (d) Projection length (L)



Accessories

Stopper Bolt BL (P.068)	Straight Collet MC (P.066) MCA (P.067)	Morse Taper Adapter MA (P.068) MAB (P.068)	Jacobs Adapter JA (P.069) JAB (P.069)
--------------------------	-------------------------------------------	-----------------------------------------------	------------------------------------------

Min. chucking length

Without MC collet		With MC collet		
I.D. of Milling Chuck	Min. chucking length	Collet I.D.	Min. chucking length	
			MC	MC-C, MC-OH
16, 20	40	6, 8	30	30
25, 32, 42	50	10, 12	40	40
		16, 20	45	45
		25	50	50
		32	50	60



- BT
- CAT
- AHO
- HSK-A/E/F/C
- HSK-T
- UTS
- Specialized Machine
- Related Equipment
- Bush & Chamfering Drill
- Milling Chuck
- Collet Holder
- "R" Zero Holder
- Hydraulic Chuck
- Shrink Fit
- Tapping Chuck
- Arbors
- Function Holder
- Turning Tool
- Retention Stud
- Tool Shank Dimensions

CT·S

Super tite-lock Milling Chuck

- Slim design milling chuck. Specially designed slits enable heavy endmilling.

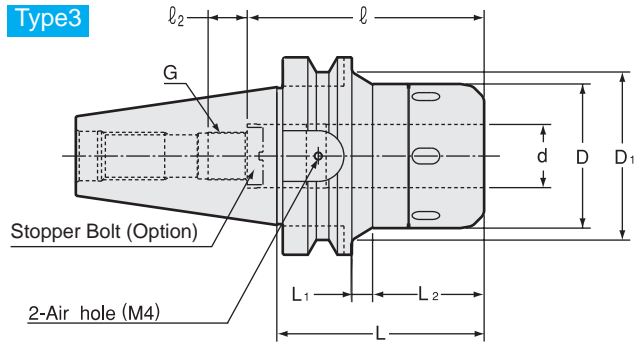
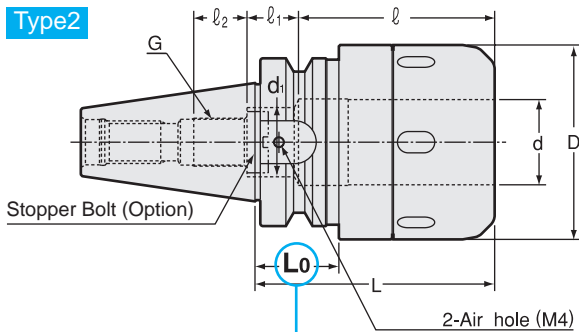
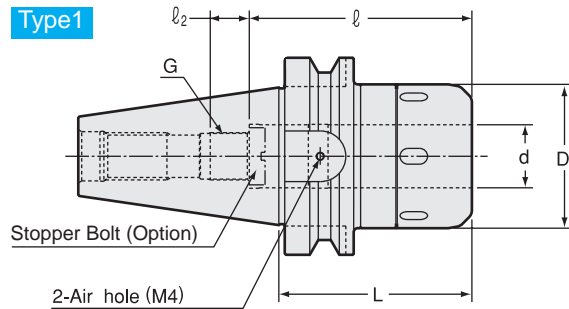
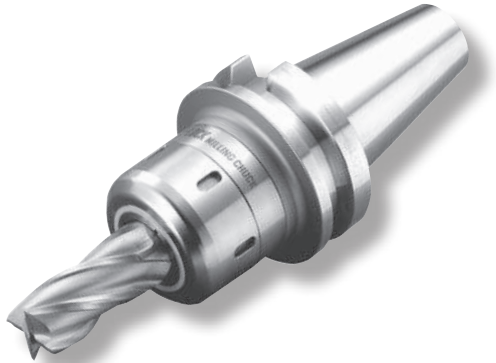

Caution

- ★ Take caution against A.T.C. arm and tool magazine interference.

Caution

- Please rotate the clamping ring counterclockwise more than 360 degrees after a cutting tool is removed.

Metric Sizes

Unit : Metric

Code	Model	Type	d	D	D1	L	L1	L2	ℓ	ℓ_1	ℓ_2	d1	L0	$G_{P=1.0}$	kg	Spanner	
3140 00116075	BT30 -CT16S -75	1	16	45	—	75	—	—	65	—	15	—	—	10	0.9	HS-1-16	
3140 00116090	-90	1	16	45	—	90	—	—	65	—	15	—	—	10	1.1		
3140 00120075	BT30 -CT20S -75 * 1	2	20	52	—	75	—	—	65	—	15	—	★ 27	12	1.0	HS-2-20	
3140 00120090	-90	2	20	52	—	90	—	—	80	—	15	—	—	42	12		1.2
3140 00120105	-105	2	20	52	—	105	—	—	80	—	15	—	—	57	12		1.3
3140 00125090	BT30 -CT25S -90	2	25	61	—	90	—	—	80	—	15	—	★ 31	12	1.4	HS-2.5-25	
3140 00125105	-105	2	25	61	—	105	—	—	80	—	15	—	—	44	12		1.6
3140 00132090	BT30 -CT32S -90	2	32	68	—	90	—	—	68	—	20	—	★ 30	18	1.6	HS-3-32	
3140 00316075	BT40 -CT16S -75	1	16	45	—	75	—	—	65	—	15	—	—	10	1.4	HS-1-16	
3140 00316090	-90	1	16	45	—	90	—	—	65	—	15	—	—	10	1.6		
3140 00320075	BT40 -CT20S -75	1	20	52	—	75	—	—	75	—	15	—	—	12	1.5	HS-2-20	
3140 00320090	-90	1	20	52	—	90	—	—	80	—	15	—	—	12	1.8		
3140 00320105	-105	1	20	52	—	105	—	—	80	—	15	—	—	12	2.1		
3140 00320120	-120	1	20	52	—	120	—	—	80	—	15	—	—	12	2.3	HS-2.5-25	
3140 00325090	BT40 -CT25S -90	1	25	61	—	90	—	—	80	—	15	—	—	12	2.0		
3140 00325105	-105	1	25	61	—	105	—	—	80	—	15	—	—	12	2.3		
3140 00325120	-120	1	25	61	—	120	—	—	80	—	15	—	—	12	2.7	HS-3-32	
3140 00325135	-135	1	25	61	—	135	—	—	80	—	15	—	—	12	3.0		
3140 00332090	BT40 -CT32S -90 * 2	2	32	73	—	90	—	—	76	32	17	26	★ 31	18	2.3	HS-3-32	
3140 00332105	-105 * 3	2	32	73	—	105	—	—	85	23	17	26	46	18	2.5		
3140 00332120	-120 * 3	2	32	73	—	120	—	—	85	23	17	26	61	18	2.9		
3140 00332135	-135	2	32	73	—	135	—	—	120	—	17	26	76	18	3.2		

Metric Sizes Unit : Metric



Code	Model	Type	d	D	D1	L	L1	L2	ℓ	ℓ1	ℓ2	d1	L0	G P=1.0	kg	Spanner
3140 00516090	BT50 -CT16S -90	3	16	45	58	90	7	45	65	—	20	—	—	10	4.1	HS-1-16
3140 00516105	-105	3	16	45	70	105	22	45	65	—	20	—	—	10	4.4	
3140 00516135	-135	3	16	45	70	135	37	45	65	—	20	—	—	10	5.0	
3140 00520090	BT50 -CT20S -90	3	20	52	65	90	7	45	80	—	15	—	—	12	4.2	HS-2-20
3140 00520105	-105	3	20	52	70	105	9	58	80	—	15	—	—	12	4.5	
3140 00520120	-120	3	20	52	70	120	24	58	80	—	15	—	—	12	4.9	
3140 00520135	-135	3	20	52	73	135	39	58	80	—	15	—	—	12	5.4	
3140 00520165	-165	3	20	52	73	165	69	58	80	—	15	—	—	12	6.1	
3140 00520200	-200	3	20	52	73	200	104	58	80	—	15	—	—	12	6.8	
3140 00520250	-250	3	20	52	73	250	154	58	80	—	15	—	—	12	7.9	
3140 00520300	-300	3	20	52	73	300	204	58	80	—	15	—	—	12	9.3	
3140 00525105	BT50 -CT25S -105	3	25	61	82	105	11	56	80	—	15	—	—	12	4.8	
3140 00525120	-120	3	25	61	82	120	26	56	80	—	15	—	—	12	5.2	
3140 00525135	-135	3	25	61	83	135	41	56	80	—	15	—	—	12	5.7	
3140 00525165	-165	3	25	61	86	165	71	56	80	—	15	—	—	12	6.6	
3140 00525200	-200	3	25	61	86	200	106	56	80	—	15	—	—	12	7.7	
3140 00525250	-250	3	25	61	86	250	156	56	80	—	15	—	—	12	9.2	
3140 00525300	-300	3	25	61	86	300	206	56	80	—	15	—	—	12	10.8	
3140 00532095	BT50 -CT32S -95	1	32	73	—	95	—	—	120	—	20	—	—	18	4.6	HS-3-32
3140 00532105	-105	1	32	73	—	105	—	—	120	—	20	—	—	18	4.9	
3140 00532120	-120	3	32	73	87	120	26	56	120	—	20	—	—	18	5.6	
3140 00532135	-135	3	32	73	88	135	41	56	120	—	20	—	—	18	6.2	
3140 00532150	-150	3	32	73	87	150	56	56	120	—	20	—	—	18	6.7	
3140 00532165	-165	3	32	73	86	165	71	56	120	—	20	—	—	18	7.2	
3140 00532200	-200	3	32	73	88	200	106	56	120	—	20	—	—	18	8.6	
3140 00532250	-250	3	32	73	88	250	156	56	120	—	20	—	—	18	10.5	
3140 00532300	-300	3	32	73	88	300	206	56	120	—	20	—	—	18	12.4	
3140 00542095	BT50 -CT42S -95 * 4	1	42	88	—	95	—	—	120	—	20	—	—	18	5.0	
3140 00542105	-105 * 4	1	42	88	—	105	—	—	120	—	20	—	—	18	5.4	
3140 00542120	-120	1	42	88	—	120	—	—	120	—	20	—	—	18	6.1	
3140 00542135	-135	1	42	88	—	135	—	—	120	—	20	—	—	18	6.8	
3140 00542150	-150	1	42	88	—	150	—	—	120	—	20	—	—	18	7.4	
3140 00542165	-165	1	42	88	—	165	—	—	120	—	20	—	—	18	8.1	
3140 00542200	-200	1	42	88	—	200	—	—	120	—	20	—	—	18	9.7	
3140 00542250	-250	1	42	88	—	250	—	—	120	—	20	—	—	18	12.0	
3140 00542300	-300	1	42	88	—	300	—	—	120	—	20	—	—	18	14.2	

1. Use 2pcs. of M4 x 5 (S) hex. screw (included) to close air holes on the holder when internal coolant is used.
2. When ordering, indicate number of spanners required. "No charge" spanners are limited to number of milling chucks on order.
3. Tolerance of cutting tool shank must be h7.

Ordering Example
BT30 - CT 16 S - 75
 Shank size I.D. (d) Projection length (L)

Spanner
P. 069

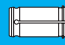
Accessories Models with * 1 - * 4 cannot be used with some accessories due to short ℓ length.

	Stopper Bolt 	Straight Collet 		Morse Taper Adapter 		Jacobs Adapter 	
	BL (P.068)	MC (P.066)	MCA (P.067)	MA (P.068)	MAB (P.068)	JA (P.069)	JAB (P.069)
* 1	Yes	Yes	No	No	No	No	No
* 2	Yes	Yes	No	No	Yes	No	Yes
* 3	Yes	Yes	Yes	No	Yes	No	Yes
* 4	Yes	Yes	No	Yes	Yes	Yes	Yes

Min. chucking length

Without MC collet		Unit : Metric	With MC collet		Unit : Metric
I.D. of Milling Chuck	Min. chucking length		Collet I.D.	Min. chucking length	
				MC	MC-C, MC-OH
16, 20	40		6, 8	30	30
25, 32, 42	50		10, 12	40	40
			16, 20	45	45
			25	50	50
			32	50	60



CT·S

Super tite-lock Milling Chuck

- Slim design milling chuck. Specially designed slits enable heavy endmilling.

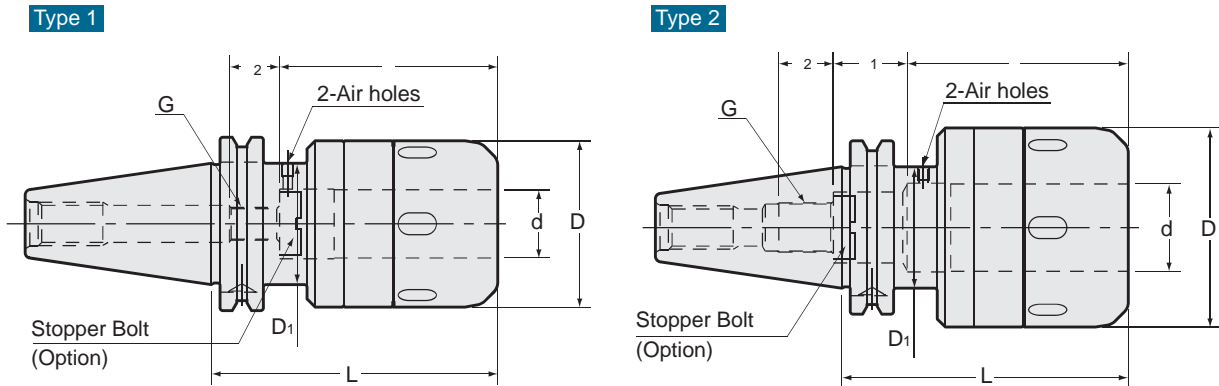

Caution

Please rotate the clamping ring counterclockwise more than 360 degrees after a cutting tool is removed.

Inch Sizes

Unit : Inch

Code	Model	Type	d	D	D1	L	ℓ	ℓ1	ℓ2	G P=1.0	Kg	Spanner
01910010424090	CAT40 -CT0750S - 90	1	0.750	2.047	1.750	3.543	3.150	—	0.591	M12	1.7	HS-2-20
01910010424105	-105	1	0.750	2.047	1.750	4.134	3.150	—	0.591	M12	1.9	
01910010424120	-120	1	0.750	2.047	1.750	4.724	3.150	—	0.591	M12	2.1	
01910010432105	CAT40 -CT1000S -105	1	1.000	2.402	1.750	4.134	3.150	—	0.591	M12	2.2	HS-2.5-25
01910010432120	-120	1	1.000	2.402	1.750	4.724	3.150	—	0.591	M12	2.5	
01910010432135	-135	1	1.000	2.402	1.750	5.315	3.150	—	0.591	M12	2.8	
01910010440105	CAT40 -CT1250S -105	2	1.250	2.874	1.750	4.134	3.346	0.906	0.787	M18	2.5	HS-3-32
01910010440120	-120	2	1.250	2.874	1.750	4.724	3.346	0.906	0.787	M18	3.0	
01910010440135	-135	2	1.250	2.874	1.750	5.315	4.724	—	0.787	M18	3.4	
01910010524090	CAT50 -CT0750S -90	1	0.750	2.047	2.750	3.543	3.150	—	0.591	M12	3.7	HS-2-20
01910010524105	-105	1	0.750	2.047	2.750	4.134	3.150	—	0.591	M12	3.9	
01910010524135	-135	1	0.750	2.047	2.750	5.315	3.150	—	0.591	M12	4.3	
01910010532105	CAT50 -CT1000S -105	1	1.000	2.402	2.750	4.134	3.150	—	0.591	M12	4.2	HS-2.5-25
01910010532135	-135	1	1.000	2.402	2.750	5.315	3.150	—	0.591	M12	4.8	
01910010532165	-165	1	1.000	2.402	2.750	6.496	3.150	—	0.591	M12	5.3	
01910010540095	CAT50 -CT1250S -95	1	1.250	2.874	2.750	3.740	4.724	—	0.787	M18	4.2	HS-3-32
01910010540105	-105	1	1.250	2.874	2.750	4.134	4.724	—	0.787	M18	4.5	
01910010540120	-120	1	1.250	2.874	2.750	4.724	4.724	—	0.787	M18	4.9	
01910010540135	-135	1	1.250	2.874	2.750	5.315	4.724	—	0.787	M18	5.4	HS-4V
01910010540150	-150	1	1.250	2.874	2.750	5.906	4.724	—	0.787	M18	0.0	
01910010540165	-165	1	1.250	2.874	2.750	6.496	4.724	—	0.787	M18	6.3	
01910010564105	CAT50 -CT2000S -105	1	2.000	4.134	2.750	4.134	3.937	—	0.787	M18	5.9	HS-4V
01910010564120	-120	1	2.000	4.134	2.750	4.724	3.937	—	0.787	M18	6.9	
01910010564135	-135	1	2.000	4.134	2.750	5.315	3.937	—	0.787	M18	7.8	
01910010564150	-150	1	2.000	4.134	2.750	5.906	3.937	—	0.787	M18	0.0	
01910010564165	-165	1	2.000	4.134	2.750	6.496	3.937	—	0.787	M18	9.7	

1. Use 2 pcs. of M4 × 5 (S) hex. screw to close air holes on the holder when internal coolant is used.

2. When ordering, indicate number of spanners required. "No charge" spanners are limited to number of milling chucks on order.

3. Tolerance of cutting tool shank must be h7.

Ordering Example

CAT40 - CT 0750 S - 90

Shank size

I.D. (d)

Projection
length (L)

Metric Sizes

Unit : Inch

Code	Model	Type	d (mm)	D	D1	L	ℓ	ℓ1	ℓ2	G P=1.0	Kg	Spanner
01910000416090	CAT40 -CT16S -90	1	16	1.772	1.750	3.543	2.559	—	0.787	M10	1.5	HS-1-16
01910000420090	CAT40 -CT20S -90	1	20	2.047	1.750	3.543	3.150	—	0.591	M12	1.7	HS-2-20
01910000420105	-105	1	20	2.047	1.750	4.134	3.150	—	0.591	M12	1.9	
01910000420120	-120	1	20	2.047	1.750	4.724	3.150	—	0.591	M12	2.1	
01910000425105	CAT40 -CT25S -105	1	25	2.402	1.750	4.134	3.150	—	0.591	M12	2.2	HS-2.5-25
01910000425120	-120	1	25	2.402	1.750	4.724	3.150	—	0.591	M12	2.5	
01910000425135	-135	1	25	2.402	1.750	5.315	3.150	—	0.591	M12	2.8	
01910000432105	CAT40 -CT32S -105	2	32	2.874	1.750	4.134	3.346	0.906	0.787	M18	2.5	HS-3-32
01910000432120	-120	2	32	2.874	1.750	4.724	3.346	0.906	0.787	M18	3.0	
01910000432135	-135	2	32	2.874	1.750	5.315	4.724	—	0.787	M18	3.4	
01910000516090	CAT50 -CT16S -90	1	16	1.772	2.750	3.543	2.559	—	0.787	M10	-	HS-1-16
01910000516105	-105	1	16	1.772	2.750	4.134	2.559	—	0.787	M10	3.7	
01910000520090	CAT50 -CT20S -90	1	20	2.047	2.750	3.543	3.150	—	0.591	M12	-	HS-2-20
01910000520105	-105	1	20	2.047	2.750	4.134	3.150	—	0.591	M12	3.9	
01910000520135	-135	1	20	2.047	2.750	5.315	3.150	—	0.591	M12	4.3	
01910000525105	CAT50 -CT25S -105	1	25	2.402	2.750	4.134	3.150	—	0.591	M12	4.2	HS-2.5-25
01910000525135	-135	1	25	2.402	2.750	5.315	3.150	—	0.591	M12	4.8	
01910000525165	-165	1	25	2.402	2.750	6.496	3.150	—	0.591	M12	5.3	
01910000532095	CAT50 -CT32S -95	1	32	2.874	2.750	3.740	4.724	—	0.787	M18	4.2	HS-3-32
01910000532105	-105	1	32	2.874	2.750	4.134	4.724	—	0.787	M18	4.5	
01910000532120	-120	1	32	2.874	2.750	4.724	4.724	—	0.787	M18	4.9	
01910000532135	-135	1	32	2.874	2.750	5.315	4.724	—	0.787	M18	5.4	
01910000532150	-150	1	32	2.874	2.750	5.906	4.724	—	0.787	M18	5.8	
01910000532165	-165	1	32	2.874	2.750	6.496	4.724	—	0.787	M18	6.3	
01910000542105	CAT50 -CT42S -105	1	42	3.465	2.750	4.134	4.724	—	0.787	M18	5.0	
01910000542120	-120	1	42	3.465	2.750	4.724	4.724	—	0.787	M18	5.6	
01910000542135	-135	1	42	3.465	2.750	5.315	4.724	—	0.787	M18	6.3	
01910000542150	-150	1	42	3.465	2.750	5.906	4.724	—	0.787	M18	6.9	
01910000542165	-165	1	42	3.465	2.750	6.496	4.724	—	0.787	M18	7.6	

1. Use 2 pcs. of M4 x 5 (S) hex. screw to close air holes on the holder when internal coolant is used.

2. When ordering, indicate number of spanners required. "No charge" spanners are limited to number of milling chucks on order.

3. Tolerance of cutting tool shank must be h7.

Ordering Example

CAT40 - CT 16 S - 90

Shank size

I.D. (d)

Projection
length (L)

Spanner

P. 069



Accessories

Stopper Bolt 
BL (P.068)

Straight Collet 
MC (P.066) | MCA (P.067)

Morse Taper Adapter 
MA (P.068) | MAB (P.068)

Jacobs Adapter 
JA (P.069) | JAB (P.069)

Min. chucking length

Without MC collet

I.D. of Milling Chuck	Min. chucking length
16, 20	40
25, 32, 42	50

With MC collet

Collet I.D.	Min. chucking length	
	MC	MC-C, MC-OH
6, 8	30	30
10, 12	40	40
16, 20	45	45
25	50	50
32	50	60

CT·S

Super tite-lock Milling Chuck

● Slim design milling chuck. Specially designed slits enables heavy endmilling.

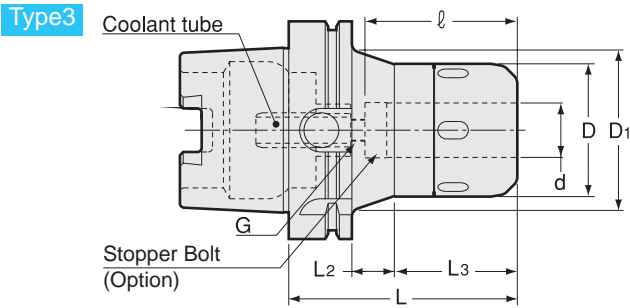
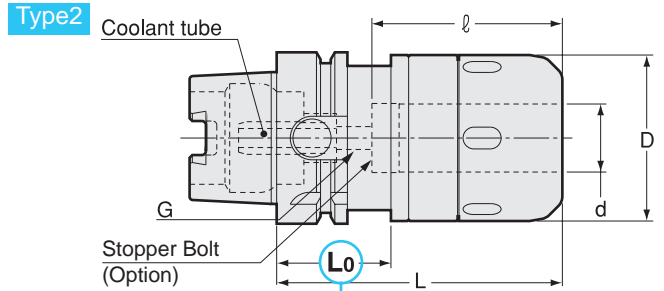
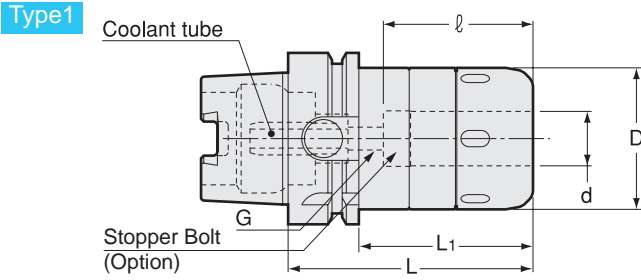

Caution
★ Take caution against A.T.C. arm and tool magazine interference.

Caution

Please rotate the clamping ring counterclockwise more than 360 degrees after a cutting tool is removed.

● Coolant tube is included.

Inch Sizes Unit : Inch

Code	Model	Type	d	D	D1	L	L1	L2	L3	ℓ	L0	G	kg	Spanner
5690 13124090	HSK40A -CT0750S -90	2	0.750	2.047	-	3.543	-	-	-	2.362	1.378	M5	1.0	HS-2-20
5690 13132105	HSK40A -CT1000S -105	2	1.000	2.402	-	4.134	-	-	-	2.362	1.378	M5	1.6	HS-2.5-25
5690 15124090	HSK63A -CT0750S -90	1	0.750	2.047	-	3.543	2.520	-	-	2.362	-	M8	1.5	HS-2-20
5690 15124105	-105	1	0.750	2.047	-	4.134	3.110	-	-	2.953	-	M8	1.8	
5690 15124135	-135	1	0.750	2.047	-	5.315	4.291	-	-	3.150	-	M8	2.2	
5690 15132105	HSK63A -CT1000S -105	2	1.000	2.402	-	4.134	-	-	-	2.953	1.654	M8	2.0	HS-2.5-25
5690 15132120	-120	2	1.000	2.402	-	4.724	-	-	-	2.953	1.654	M8	2.3	
5690 15132135	-135	2	1.000	2.402	-	5.315	-	-	-	3.150	1.654	M8		
5690 15140105	HSK63A -CT1250S -105	2	1.250	2.874	-	4.134	-	-	-	2.953	1.654	M8	2.4	HS-3-32
5690 15140120	-120	2	1.250	2.874	-	4.724	-	-	-	3.543	1.654	M8	2.7	
5690 15140150	-150	2	1.250	2.874	-	5.906	-	-	-	4.724	1.654	M8	3.5	
5690 17124090	HSK100A -CT0750S -90 *	3	0.750	2.047	2.913	3.543	-	0.630	1.772	2.165	-	M10	2.9	HS-2-20
5690 17124105	-105	3	0.750	2.047	2.913	4.134	-	1.220	1.772	2.756	-	M10	3.2	
5690 17124135	-135	3	0.750	2.047	2.913	5.315	-	2.402	1.772	3.150	-	M10		
5690 17124150	-150	3	0.750	2.047	2.913	5.906	-	2.992	1.772	3.150	-	M10		
5690 17132090	HSK100A -CT1000S -90 *	1	1.000	2.402	-	3.543	2.402	-	-	2.165	-	M10		HS-2.5-25
5690 17132105	-105	3	1.000	2.402	2.913	4.134	-	0.787	2.205	2.756	-	M10	3.5	
5690 17132135	-135	3	1.000	2.402	2.913	5.315	-	1.969	2.205	3.150	-	M10		
5690 17132150	-150	3	1.000	2.402	2.913	5.906	-	2.559	2.205	3.150	-	M10	4.7	
5690 17140090	HSK100A -CT1250S -90 *	1	1.250	2.874	-	3.543	2.402	-	-	2.165	-	M10		HS-3-32
5690 17140105	-105	1	1.250	2.874	-	4.134	2.992	-	-	2.756	-	M10	4.0	
5690 17140120	-120	1	1.250	2.874	-	4.724	3.583	-	-	3.346	-	M10		
5690 17140135	-135	1	1.250	2.874	-	5.315	4.173	-	-	3.937	-	M10	4.8	
5690 17140150	-150	1	1.250	2.874	-	5.906	4.764	-	-	4.528	-	M10	5.2	
5690 17164110	HSK100A -CT2000S -110 *	2	2.000	4.134	-	4.331	-	-	-	2.756	1.772	M10	5.8	HS-4V
5690 17164135	-135	2	2.000	4.134	-	5.315	-	-	-	3.937	1.772	M10		
5690 17164150	-150	2	2.000	4.134	-	5.906	-	-	-	4.331	1.772	M10		
5690 17164165	-165	2	2.000	4.134	-	6.496	-	-	-	4.724	1.772	M10		

1. When ordering, indicate number of spanners required. "No charge" spanners are limited to number of milling chucks on order.
2. Tolerance of cutting tool shank must be h7.

Ordering Example

HSK40A - CT 0750 S - 90
 Shank size I.D. (d) Projection length (L)

Metric Sizes

Unit : Metric

Code	Model	Type	d	D	D1	L	L1	L2	L3	ℓ	L0	G	kg	Spanner
5690 13016075	HSK40A -CT16S -75	2	16	45	—	75	—	—	—	50	★ 26	M5	0.8	HS-1-16
5690 13016090	-90 * 1	2	16	45	—	90	—	—	—	60	35	M5	0.9	
5690 13020090	HSK40A -CT20S -90 * 2	2	20	52	—	90	—	—	—	60	35	M5	1.0	HS-2-20
5690 13020105	-105 * 2	2	20	52	—	105	—	—	—	60	35	M5	1.2	
5690 13025105	HSK40A -CT25S -105 * 2	2	25	61	—	105	—	—	—	60	35	M5	1.6	HS-2.5-25
5690 14016090	HSK50A -CT16S -90 * 1	2	16	45	—	90	—	—	—	60	42	M5	1.1	HS-1-16
5690 14020090	HSK50A -CT20S -90 * 2	2	20	52	—	90	—	—	—	60	42	M5	1.2	HS-2-20
5690 14020105	-105 * 2	2	20	52	—	105	—	—	—	60	42	M5	1.4	
5690 14025105	HSK50A -CT25S -105 * 1	2	25	61	—	105	—	—	—	75	42	M5	1.6	HS-2.5-25
5690 15016075	HSK63A -CT16S -75 * 2	1	16	45	—	75	49	—	—	47	—	M8	1.2	HS-1-16
5690 15016090	-90	1	16	45	—	90	64	—	—	60	—	M8	1.3	
5690 15020090	HSK63A -CT20S -90 * 2	1	20	52	—	90	64	—	—	60	—	M8	1.5	HS-2-20
5690 15020105	-105 * 1	1	20	52	—	105	79	—	—	75	—	M8	1.7	
5690 15020135	-135 * 1	1	20	52	—	135	109	—	—	80	—	M8	2.2	
5690 15025105	HSK63A -CT25S -105 * 1	2	25	61	—	105	—	—	—	75	42	M8	2.0	HS-2.5-25
5690 15025120	-120 * 1	2	25	61	—	120	—	—	—	75	42	M8	2.3	
5690 15025135	-135 * 1	2	25	61	—	135	—	—	—	80	42	M8	2.7	
5690 15032105	HSK63A -CT32S -105 * 3	2	32	73	—	105	—	—	—	75	42	M8	2.4	HS-3-32
5690 15032120	-120 * 3	2	32	73	—	120	—	—	—	90	42	M8	2.7	
5690 15032150	-150 * 1	2	32	73	—	150	—	—	—	120	42	M8	3.5	
5690 17016090	HSK100A -CT16S -90 * 2	3	16	45	56	90	—	16	45	55	—	M10	2.8	HS-1-16
5690 17016105	-105	3	16	45	56	105	—	31	45	70	—	M10	2.9	
5690 17020090	HSK100A -CT20S -90 * 6	3	20	52	64	90	—	16	45	55	—	M10	2.9	HS-2-20
5690 17020105	-105 * 4	3	20	52	64	105	—	18	58	70	—	M10	3.3	
5690 17020120	-120	3	20	52	64	120	—	33	58	80	—	M10	3.5	
5690 17020135	-135	3	20	52	64	135	—	48	58	80	—	M10	3.7	
5690 17020150	-150	3	20	52	64	150	—	63	58	80	—	M10	4.1	
5690 17025090	HSK100A -CT25S -90 * 6	1	25	61	—	90	61	—	—	55	—	M10	3.1	
5690 17025105	-105 * 5	3	25	61	74	105	—	20	56	70	—	M10	3.5	HS-2.5-25
5690 17025120	-120	3	25	61	74	120	—	35	56	80	—	M10	3.9	
5690 17025135	-135	3	25	61	74	135	—	50	56	80	—	M10	4.3	
5690 17025150	-150	3	25	61	73	150	—	65	56	80	—	M10	4.7	
5690 17032090	HSK100A -CT32S -90 * 6	1	32	73	—	90	61	—	—	55	—	M10	3.6	HS-3-32
5690 17032105	-105 * 2	1	32	73	—	105	76	—	—	70	—	M10	4.0	
5690 17032120	-120 * 3	1	32	73	—	120	91	—	—	85	—	M10	4.4	
5690 17032135	-135 * 1	1	32	73	—	135	106	—	—	100	—	M10	4.8	
5690 17032150	-150 * 1	1	32	73	—	150	121	—	—	115	—	M10	5.2	HS-4-42
5690 17042105	HSK100A -CT42S -105 * 6	2	42	88	—	105	—	—	—	70	45	M10	4.7	
5690 17042120	-120 * 2	2	42	88	—	120	—	—	—	85	45	M10	5.2	
5690 17042135	-135 * 2	2	42	88	—	135	—	—	—	100	45	M10	5.8	
5690 17042150	-150 * 2	2	42	88	—	150	—	—	—	110	45	M10	6.4	HS-4-42
5690 17042165	-165 * 1	2	42	88	—	165	—	—	—	120	45	M10	7.0	

- When ordering, indicate number of spanners required. "No charge" spanners are limited to number of milling chucks on order.
- Tolerance of cutting tool shank must be h7.

Ordering Example

HSK40A - CT 16 S - 90





Shank size

I.D. (d)

Projection length (L)

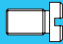
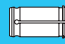
Accessories

Models with * 1 - * 6 cannot be used with some accessories due to short ℓ length.

	Stopper Bolt 	Straight Collet 		Morse Taper Adapter 		Jacobs Adapter 		Spanner 
	BL (P.295)	MC (P.066)	MCA (P.067)	MA (P.068)	MAB (P.068)	JA (P.069)	JAB (P.069)	
* 1	Yes	Yes	No	Yes	Yes	Yes	Yes	P. 069
* 2	Yes	Yes	No	No	No	No	No	
* 3	Yes	Yes	No	No	Yes	No	Yes	
* 4	Yes	Yes	Yes	Yes	No	Yes	No	
* 5	Yes	Yes	Yes	No	No	Yes	No	
* 6	Yes	No	No	No	No	No	No	

Min. chucking length

Without MC collet

I.D. of Milling Chuck	Min. chucking length
16, 20	40
25, 32, 42	50

With MC collet

Collet I.D.	Min. chucking length	
	MC	MC-C, MC-OH
6, 8	30	30
10, 12	40	40
16, 20	45	45
25	50	50
32	50	60

CT·S

Super tite-lock Milling Chuck

● Slim design milling chuck. Specially designed slits enable heavy endmilling.

Type1

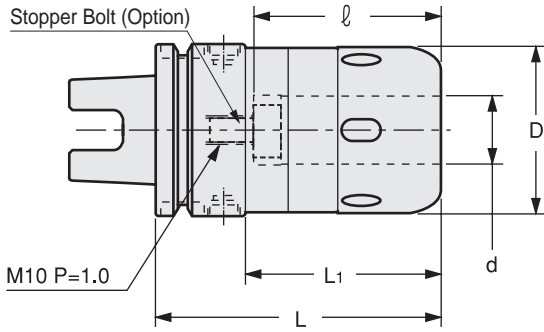

Type2

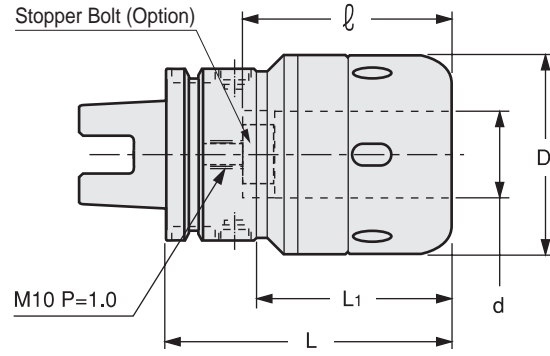

Caution

Please rotate the clamping ring counterclockwise more than 360 degrees after a cutting tool is removed.

Metric Sizes

Unit : Metric



Code	Model	Type	d	D	L	L1	ℓ	kg	Spanner
1360 01116090	UTS5040 -CT16S -90-H * 1	1	16	45	90	60	60	1.1	HS-1-16
1360 01120090	UTS5040 -CT20S -90-H * 5	2	20	52	90	60	60	1.3	HS-2-20
1360 01120105	-105-H * 1	2	20	52	105	75	75	1.5	
1360 01125105	UTS5040 -CT25S -105-H * 1	2	25	61	105	75	75	1.8	HS-2.5-25
1360 0 * 216090	UTS6350 -CT16S -90	1	16	45	90	57	65	1.5	HS-1-16
1360 0 * 220090	UTS6350 -CT20S -90 * 5	1	20	52	90	57	65	1.6	
1360 0 * 220105	-105	1	20	52	105	72	75	1.8	HS-2-20
1360 0 * 220135	-135	1	20	52	135	102	80	2.2	
1360 0 * 225105	UTS6350 -CT25S -105	1	25	61	105	72	75	2.1	
1360 0 * 225120	-120	1	25	61	120	87	75	2.5	HS-2.5-25
1360 0 * 225135	-135	1	25	61	135	102	80	2.8	
1360 0 * 232105	UTS6350 -CT32S -105 * 2	2	32	73	105	72	80	2.5	
1360 0 * 232120	-120 * 2	2	32	73	120	87	90	2.8	HS-3-32
1360 0 * 232150	-150 * 1	2	32	73	150	117	120	3.3	
1360 0 * 316090	UTS10080 -CT16S -90	1	16	45	90	56	65	3.0	HS-1-16
1360 0 * 316105	-105	1	16	45	105	71	65	3.4	
1360 0 * 320090	UTS10080 -CT20S -90 * 5	1	20	52	90	56	65	3.2	
1360 0 * 320105	-105 * 3	1	20	52	105	71	70	3.5	
1360 0 * 320120	-120	1	20	52	120	86	80	3.9	HS-2-20
1360 0 * 320135	-135	1	20	52	135	101	80	4.2	
1360 0 * 320150	-150	1	20	52	150	116	80	4.6	
1360 0 * 325105	UTS10080 -CT25S -105 * 4	1	25	61	105	71	70	3.8	
1360 0 * 325120	-120	1	25	61	120	86	80	4.1	HS-2.5-25
1360 0 * 325135	-135	1	25	61	135	101	80	4.5	
1360 0 * 325150	-150	1	25	61	150	116	80	5.0	
1360 0 * 332105	UTS10080 -CT32S -105 * 5	1	32	73	105	71	70	4.2	
1360 0 * 332120	-120 * 2	1	32	73	120	86	85	4.6	HS-3-32
1360 0 * 332135	-135 * 1	1	32	73	135	101	100	5.0	
1360 0 * 332150	-150 * 1	1	32	73	150	116	115	5.4	
1360 0 * 342120	UTS10080 -CT42S -120 * 5	1	42	88	120	86	85	5.4	
1360 0 * 342135	-135 * 5	1	42	88	135	101	100	6.0	HS-4-42
1360 0 * 342150	-150 * 5	1	42	88	150	116	110	6.6	
1360 0 * 342165	-165 * 1	1	42	88	165	131	120	7.2	

When placing an order, please specify high or low pressure. For high pressure type, please add (-H) on end of the description.

1. When ordering, indicate number of spanners required. "No charge" spanners are limited to number of milling chucks on order.
2. Tolerance of cutting tool shank must be h7.
3. UTS5040 is available in high pressure only.

Accessories

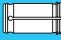
Models with * 1 - * 5 cannot be used with some accessories due to short l length.

	Stopper Bolt 	Straight Collet 		Morse Taper Adapter 		Jacobs Adapter 	
	BL (P.389)	MC (P.066)	MCA (P.067)	MA (P.068)	MAB (P.068)	JA (P.069)	JAB (P.069)
* 1	BL16 only	Yes	No	Yes	Yes	Yes	Yes
* 2	BL16 only	Yes	No	No	Yes	No	Yes
* 3	BL16 only	Yes	Yes	Yes	No	Yes	No
* 4	BL16 only	Yes	Yes	No	No	Yes	No
* 5	BL16 only	Yes	No	No	No	No	No

Min. chucking length

Without MC collet

I.D.of Milling Chuck	Min. chucking length
16、 20	40
25、 32、 42	50

With MC collet

Collet I.D.	Min. chucking length	
	MC	MC-C、 MC-OH
6、 8	30	30
10、 12	40	40
16、 20	45	45
25	50	50
32	50	60

Spanner

P. 069



Ordering Example

Low pressure type

0 ~ 1.0MPa (UTS10080 : 0 ~ 2.0MPa)

UTS6350 - CT 32 S - 105
 Shank size I.D. (d) Projection length (L)

Ordering Example

High pressure type

1.1 ~ 7.0MPa (UTS10080 : 2.1 ~ 7.0MPa)

UTS6350 - CT 32 S - 105 - H
 Shank size I.D. (d) Projection length (L) High pressure type