

# Drill Jig Bushing

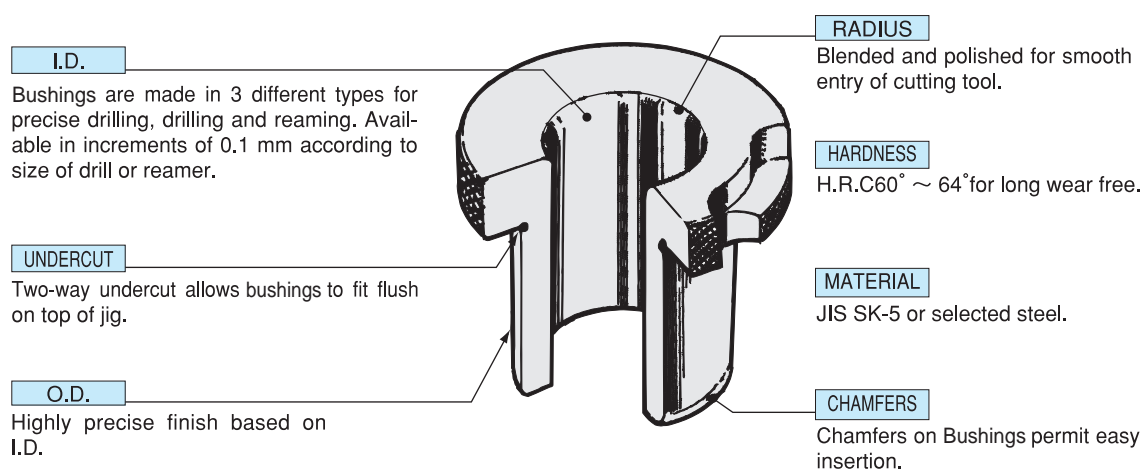

Type	PRESS FIT BUSHING		RENEWABLE BUSHING
Designation	HEADLESS Type A	HEADED Type B	ROUND Type C
Tool applied			
Shape and sequence of fitting-in			
Sectional view			

HOW TO INSTALL A JIG BUSHING	
PRESS FIT BUSHING Type A, B, G	RENEWABLE BUSHING Type C, D, E, F
<p><b>How to press-fit</b></p> <p>Press the bushing correctly into the bush plate.</p>	<p>Renewable bushing can be inserted by hand.</p>

Bushings that have the same O.D. are interchangeable with each other.

**LINER BUSHING Type G**

This Guides the renewable bushing for smoother insertion or replacement.

Name	Press fit bushing		Renewable bushing				Headless liner bushing	Lock screw	Round clamp
	Headless	Headed	Round	Right slip	Left slip	Fixed			
Shape									
Higher accuracy	<b>SA</b>	<b>SB</b>	<b>SC</b>	<b>SD</b>	<b>SE</b>	<b>SF</b>	<b>G</b>	<b>T</b>	<b>R</b>
Standard accuracy	<b>A</b>	<b>B</b>	<b>C</b>	<b>D</b>	<b>E</b>	<b>F</b>			
Reaming	—	<b>BR</b>	<b>CR</b>	<b>DR</b>	<b>ER</b>	<b>FR</b>			

S...for higher accuracy R...for reaming

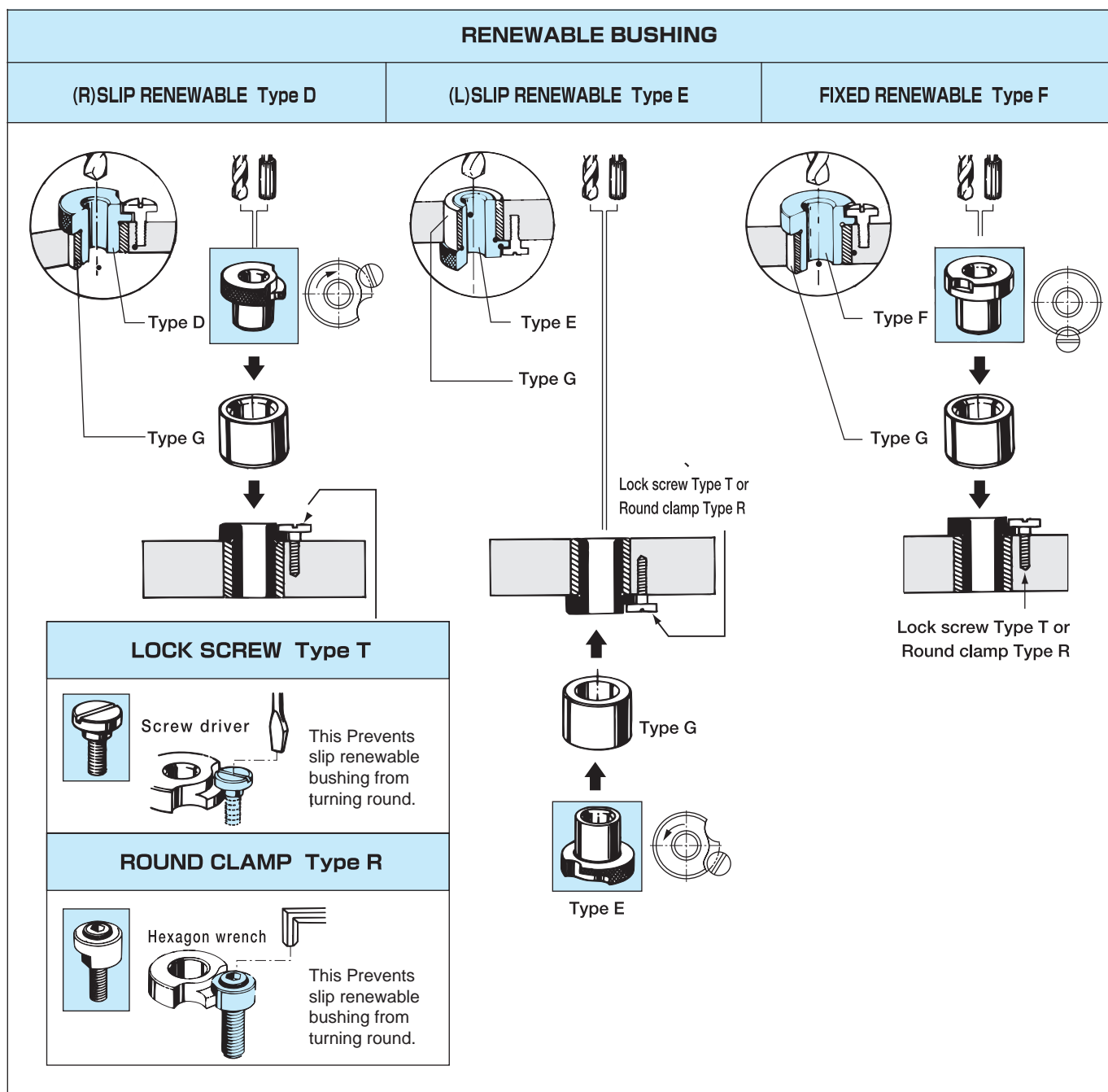

# Lock Screw Type T

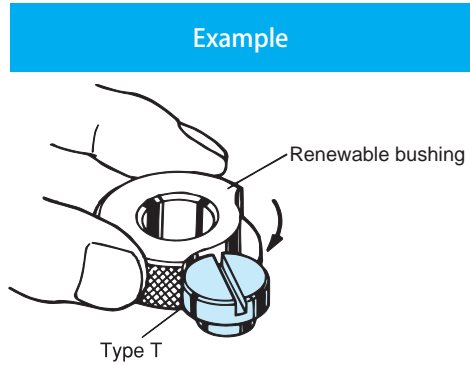
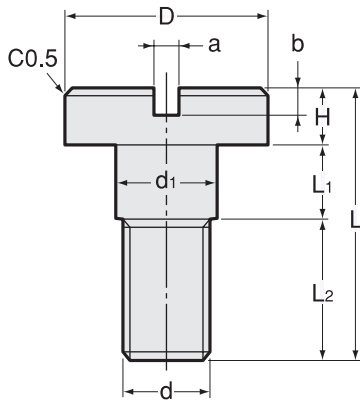

Model	d		d1	D	a	b	H	L1	L2	L
	Size	Pitch								
T-5	5	0.8 (0.9)	6 ±0.2	12 ±0.2	1.6	1.5	3	4 ±0.1	9	16
T-6	6	1	7 ±0.2	15 ±0.2	1.6	2	4	5.5 ±0.2	10.5	20
T-8	8	1.25	9 ±0.2	18 ±0.3	2	2.5	5	6.5 ±0.2	12.5	24

## Position and dimension of lock screw internal thread

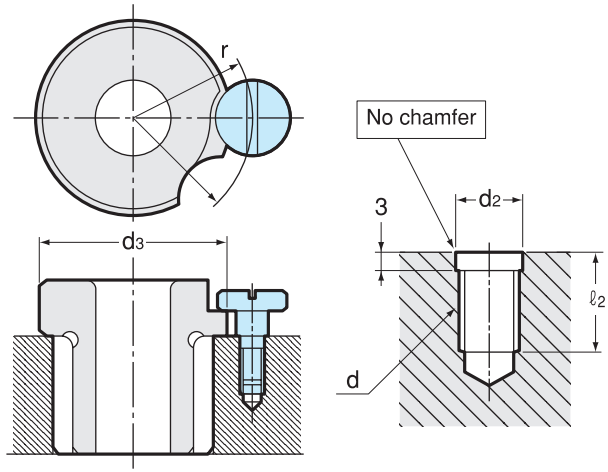

d3	d	Std size	r	Tolerance	d2	l2
16	5	12		±0.2	5.2	11
19	5	13.5		±0.2	5.2	11
22	5	15		±0.2	5.2	11
26	5	17		±0.3	5.2	11
30	5	19		±0.3	5.2	11
35	6	22		±0.3	6.2	14
40	6	24.5		±0.3	6.2	14
47	6	28		±0.3	6.2	14
55	8	33		±0.3	8.2	16
62	8	36.5		±0.3	8.2	16
69	8	40		±0.3	8.2	16
77	8	44		±0.3	8.2	16

### Ordering Example

**T - 5(0.9)**  
d Pitch

### Code

- T-5 (0.8) : 0003 00000508
- T-5 (0.9) : 0003 00000509
- T-6 : 0003 00000600
- T-8 : 0003 00000800

T-5 is available in P = 0.8 (ISO) and P = 0.9 (JIS) .When ordering, please specify P (pitch) 0.8 or 0.9.