

KH-A

Quick Change Stub Holder

- Stub drilling for special purpose machines and transfer machines.

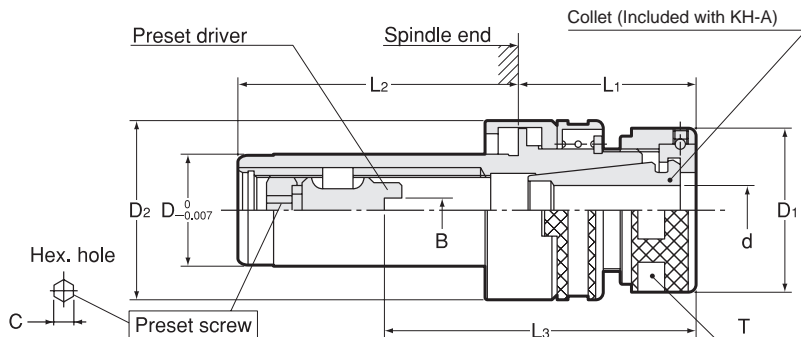

KH-A Collet set



Code	Model	D	B	Chucking range d	Preset driver	L3	D1	D2	L1	L2	C	kg	Collet	Nut	Spanner
2340 121 □□※※※	KH-12AR	12	0	0.5 ~ 6.0	KHS -00006	23 ~ 45	19	20	34	35	3	0.1	FDC-d07A	KDP-1414	Flat 17mm width
			2.4	3.1 ~ 5.0	KHS -02406	26 ~ 48									
			3.0	5.1 ~ 6.0	KHS -03006	26 ~ 48									
2340 141 □□※※※	KH-14AR	14	0	0.5 ~ 7.0	KHS -00007	23 ~ 45	19	24.3	34	35	4	0.1	FDC-d07A	KDP-1414	Flat 17mm width
			2.4	3.1 ~ 5.0	KHS -02407	26 ~ 48									
			3.0	5.1 ~ 6.0	KHS -03007	26 ~ 48									
			4.0	6.1 ~ 7.0	KHS -04007	27 ~ 48									
2340 160 □□※※※	KH-16A	16	0	2.8 ~ 9.0	KHS -00009	28 ~ 45	26	29	35	40	4	0.2	EDC-d19	KDP-1916	S-1L
			2.4	3.1 ~ 5.0	KHS -02409	31 ~ 48									
			3.0	5.1 ~ 6.0	KHS -03009	33 ~ 50									
2340 190 □□※※※	KH-19A	19	0	2.8 ~ 9.0	KHS -00009	28 ~ 50	26	32	35	45	4	0.2	EDC-d19	KDP-1916	S-1L
			2.4	3.1 ~ 5.0	KHS -02409	31 ~ 53									
			3.0	5.1 ~ 6.0	KHS -03009	33 ~ 55									
2340 200 □□※※※	KH-20A	20	0	2.8 ~ 9.0	KHS -00009	33 ~ 55	26	32	35	45	4	0.2	EDC-d19	KDP-1916	S-1L
			3.0	5.1 ~ 6.0	KHS -03009	33 ~ 55									
			4.0	6.1 ~ 9.0	KHS -04009	34 ~ 55									
2340 220 □□※※※	KH-22A	22	0	2.8 ~ 12	KHS -00012	34 ~ 61	32	35	35	55	5	0.3	EDC-d24	KDP-2422	S-3L
			2.4	3.1 ~ 5.0	KHS -02412	32 ~ 59									
			3.0	5.1 ~ 6.0	KHS -03012	32 ~ 59									
2340 240 □□※※※	KH-24A	24	4.0	6.1 ~ 9.0	KHS -04012	36 ~ 63	32	37	35	55	5	0.3	EDC-d24	KDP-2422	S-3L
			5.0	9.1 ~ 12	KHS -05012	39 ~ 63									
			0	4.0 ~ 16	KHS -00016	41 ~ 60 (65)									
2340 250 □□※※※	KH-25A	25	2.4	4.0 ~ 5.0	KHS -02416	36 ~ 58 (63)	36	41	35	60	6	0.4	EDC-d28	KDP-2825	S-4L
			3.0	5.1 ~ 6.0	KHS -03016	39 ~ 61 (66)									
			4.0	6.1 ~ 9.0	KHS -04016	42 ~ 64 (69)									
2340 260 □□※※※	KH-26A	26	5.0	9.1 ~ 12	KHS -05016	47 ~ 69 (74)	36	44	35	65	6	0.5	EDC-d28	KDP-2825	S-4L
			6.0	12.1 ~ 16	KHS -06016	51 ~ 72 (77)									
			0	4.0 ~ 22	KHS -00022	46 ~ 75									
2340 280 □□※※※	KH-28A	28	2.4	4.0 ~ 5.0	KHS -02422	39 ~ 76	46	48	40	80	6	0.7	EDC-d36	KDP-3632	S-5L
			3.0	5.1 ~ 6.0	KHS -03022	39 ~ 76									
			4.0	6.1 ~ 9.0	KHS -04022	42 ~ 79									
2340 300 □□※※※	KH-30A	30	5.0	9.1 ~ 12	KHS -05022	48 ~ 85	46	52	40	80	6	0.8	EDC-d36	KDP-3632	S-5L
			6.0	12.1 ~ 16	KHS -06022	54 ~ 91									
			8.0	16.1 ~ 22	KHS -08022	58 ~ 91									
2340 320 □□※※※	KH-32A	32	0	20.1 ~ 32	KHS -00032	66 ~ 83	65	70	45	100	6	1.8	FDC-d32B	HDP-32	S-6
			8.0	20.1 ~ 22	KHS -08032	70 ~ 89									
			12.0	22.1 ~ 32	KHS -12032	78 ~ 105									

KHB-A Holder body



Code	Model	B	L3	D	D1	D2	L1	L2	T	kg	
2340 121 □□□ 06	KHB -12AR	/00006	0	23 ~ 45	12	19	20	34	35	17	0.1
		/02406	2.4	26 ~ 48							
		/03006	3	26 ~ 48							
2340 141 □□□ 07	KHB -14AR	/00007	0	23 ~ 45	14	19	24.3	34	35	17	0.1
		/02407	2.4	26 ~ 48							
		/03007	3	26 ~ 48							
		/04007	4	27 ~ 48							
2340 160 □□□ 09	KHB -16A	/00009	0	28 ~ 45	16	26	29	35	40	24	0.15
		/02409	2.4	31 ~ 48							
		/03009	3	33 ~ 50							
		/04009	4	34 ~ 50							
2340 190 □□□ 09	KHB -19A	/00009	0	28 ~ 50	19	26	32	35	45	24	0.2
		/02409	2.4	31 ~ 53							
2340 200 □□□ 09	KHB -20A	/03009	3	33 ~ 55	20	26	32	35	45	24	0.2
		/04009	4	34 ~ 55							
2340 220 □□□ 12	KHB -22A	/00012	0	34 ~ 61	22	32	35	35	55	30	0.25
		/02412	2.4	32 ~ 59							
		/03012	3	32 ~ 59							
2340 240 □□□ 12	KHB -24A	/04012	4	36 ~ 63	24	32	37	35	55	30	0.3
		/05012	5	39 ~ 63							
2340 250 □□□ 16	KHB -25A	/00016	0	41 ~ 60(65)	25	36	41	35	60	33	0.35
2340 260 □□□ 16	KHB -26A	/02416	2.4	36 ~ 58(63)	26	36	41	35	60	33	0.35
		/03016	3	39 ~ 61(66)							
2340 280 □□□ 16	KHB -28A	/04016	4	42 ~ 64(69)	28	36	44	35	65	33	0.4
		/05016	5	47 ~ 69(74)							
2340 300 □□□ 16	KHB -30A	/06016	6	51 ~ 72(77)	30	36	44	35	65	33	0.45
2340 320 □□□ 22	KHB -32A	/00022	0	46 ~ 75	32	46	48	40	80	42	0.6
		/02422	2.4	39 ~ 76							
		/03022	3	39 ~ 76							
2340 350 □□□ 22	KHB -35A	/04022	4	42 ~ 79	35	46	52	40	80	42	0.7
		/05022	5	48 ~ 85							
2340 360 □□□ 22	KHB -36A	/06022	6	54 ~ 91	36	46	52	40	80	42	0.8
		/08022	8	58 ~ 91							
2340 480 □□□ 32	KHB -48A	/00032	0	66 ~ 83	48	65	70	45	100	-	1.6
		/08032	8	70 ~ 89							
		/12032	12	78 ~ 105							

1.L3 dimension in bracket stands for max. dimension of KH-28E & KH-30E.

2.Please select preset driver according to tang size of cutting tool. (Refer to P.433)

3.Spanner is sold separately.

4.Refer to P.440 for spindle dimension.

Collet

P. 444



Spanner

P. 446



Preset driver

P. 433

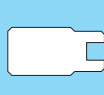

KH-A (Collet set)

Ordering Example

KH-20A / **04009** / **7.0**
Preset driver Collet I.D.

KHB-A (Holder body)

Ordering Example

KHB-20A / **04009**
Preset driver

Accessories

Preset driver (For KH-E, KH-A, KH)

Type1 without tang

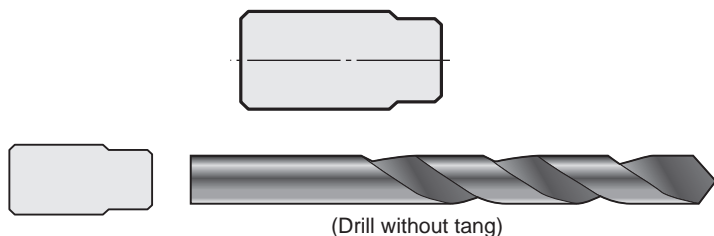

Type2 with tang

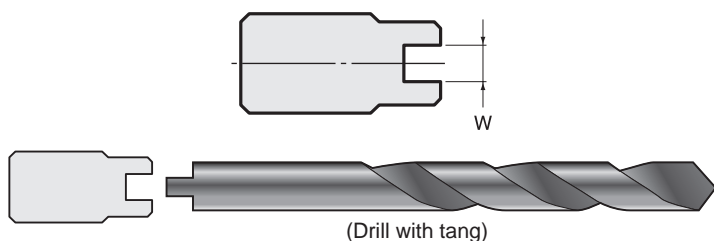

Model	Holder model	Type	W ^{+0.4} / _{+0.3}
KHS -00006	KH-12E KH-12AR	1	—
		2	2.4
		2	3
KHS -00007	KH-14E KH-14AR KH-14R	1	—
		2	2.4
		2	3
		2	4
KHS -00009	KH-16E,16A,16 KH-19E,19A,19 KH-20E,20A,20	1	—
		2	2.4
		2	3
		2	4
KHS -00012	KH-22E,22A,22 KH-24E,24A,24	1	—
		2	2.4
		2	3
		2	4
		2	5
KHS -00016	KH-25E,25A KH-26E,26A KH-28E,28A KH-30E,30A	1	—
		2	2.4
		2	3
		2	4
		2	5
		2	6
KHS -00022	KH-32E,32A KH-35E,35A KH-36E,36A	1	—
		2	2.4
		2	3
		2	4
		2	5
		2	6
KHS -00032	KH-48E KH-48A	1	—
		2	8
		2	8
		2	12

Preset driver (For KH-EC)

Type1 without tang

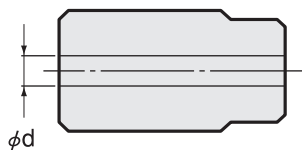

Type2 with tang

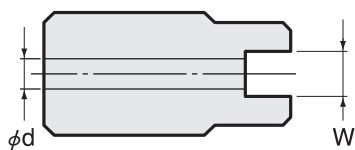

Model	Holder Model	Type	W ^{+0.4} / _{+0.3}	d
KHS 00007-OH	KHB-14EC1,2	2	2.4	2.5
		2	2.4	2.5
		2	3	2.5
		2	4	2.5
KHS 00009-OH	KHB-16EC1,2 KHB-19EC1,2 KHB-20EC1,2	2	2.4	2.5
		2	2.4	2.5
		2	3	3
		2	4	3
KHS 00012-OH	KHB-22EC1,2 KHB-24EC1,2	1	—	2.5
		2	2.4	2.5
		2	3	3
		2	4	4
		2	5	5
KHS 00016-OH	KHB-25EC1,2 KHB-26EC1,2 KHB-28EC1,2 KHB-30EC1,2	1	—	2.5
		2	3	3
		2	4	4
		2	5	5
		2	6	6
		2	8	8
KHS 00022-OH	KHB-32EC1,2 KHB-35EC1,2 KHB-36EC1,2	1	—	2.5
		2	3	3
		2	4	4
		2	5	5
		2	6	6
KHS 00032-OH	KHB-48EC1,2 KHB-48A	1	—	2.5
		2	8	8
		2	8	8
		2	12	12

Dimension for KH-A spindle

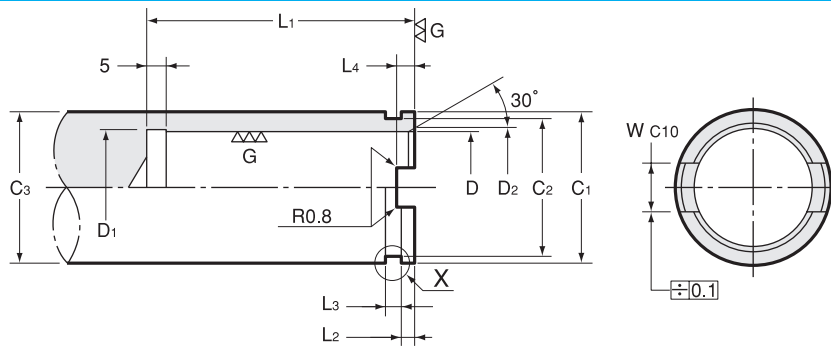

Enlarged "X"

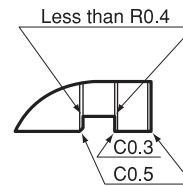

Size	D +0.015 +0.005	D1	D2	C1 0 -0.1	C2 0 -0.1	C3	L1	L2 +0.1 0	L3	W C10	L4
12AR	12	12.4	13.5	18	16.5	18 or more	38	2.5	2.5	6	3.5
14AR	14	14.4	15.5	22	20	20 or more	38	2.5	2.5	8	3.5
16A	16	16.4	17.5	26.4	24	25 or more	43	3.5	3.0	8	4.5
19A	19	19.4	20.5	29.4	27	28 or more	48	3.5	3.0	9	4.5
20A	20	20.4	21.5	29.4	27	28 or more	48	3.5	3.0	9	4.5
22A	22	22.4	23.5	32.4	30	32 or more	58	3.5	3.0	10	4.5
24A	24	24.4	25.5	34.4	32	32 or more	58	3.5	3.0	10	4.5
25A	25	25.4	26.5	37.4	35	35 or more	63	3.5	3.0	10	4.5
26A	26	26.4	27.5	37.4	35	35 or more	63	3.5	3.0	10	4.5
28A	28	28.4	29.5	40.4	38	40 or more	68	3.5	3.0	10	4.5
30A	30	30.4	31.5	40.4	38	40 or more	68	3.5	3.0	10	4.5
32A	32	32.4	33.5	43.8	41	45 or more	83	3.5	3.0	10	4.5
35A	35	35.4	36.5	47.8	45	45 or more	83	3.5	3.0	10	4.5
36A	36	36.4	37.5	47.8	45	45 or more	83	3.5	3.0	10	4.5
48A	48	48.4	49.5	65.4	62	65 or more	10	4.5	4.0	11	5.5

- Spindle dimension for KH-A only, not for KH.
- All corners not specified should be chamfered to C0.5.
 - Material of spindle end : SCM415
 - Heat treatment : HV613 ~ 697
 - Carburized depth : 0.4 ~ 0.6

Dimension for KH-spindle

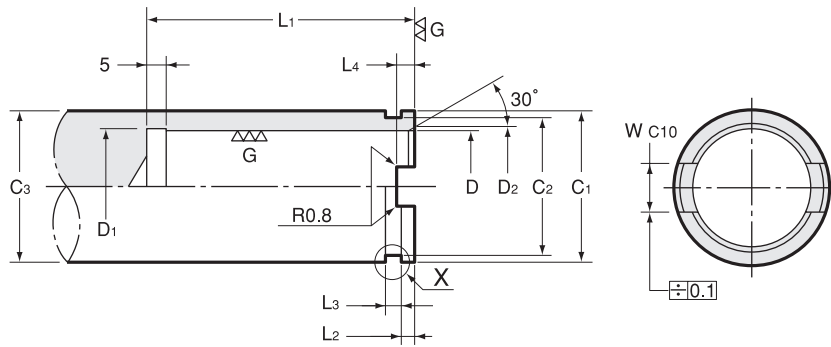

Enlarged "X"

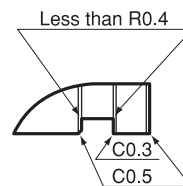

Size	D +0.015 +0.005	D1	D2	C1 0 -0.1	C2 0 -0.1	C3	L1	L2 +0.1 0	L3	W C10	L4
14	14	14.4	15.5	19.8	18	20 or more	38	2.5	2.5	8	3.5
16	16	16.4	17.5	23.8	21.4	25 or more	43	3.5	3.0	8	4.5
19	19	19.4	20.5	27.8	25.4	28 or more	48	3.5	3.0	9	4.5
20	20	20.4	21.5	27.8	25.4	28 or more	48	3.5	3.0	9	4.5
22	22	22.4	23.5	30.3	27.9	32 or more	58	3.5	3.0	10	4.5
24	24	24.4	25.5	32.3	29.9	35 or more	58	3.5	3.0	10	4.5

- Spindle dimension for KH only, not for KH-A.
- All corners not specified should be chamfered to C0.5.
 - Material of spindle end : SCM415
 - Heat treatment : HV613 - 697
 - Carburized depth : 0.4 - 0.6